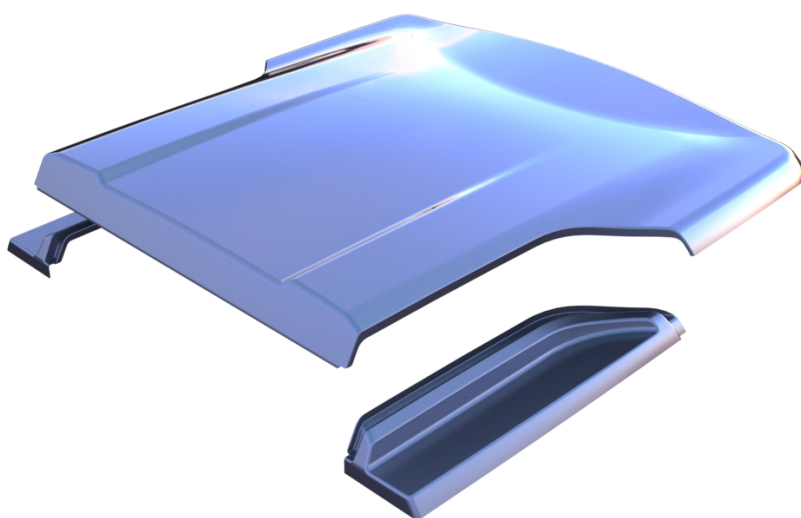


# Fitting Instructions Part Number NP15P

## Nissan NP300 Navara Dual Cab 2015+

### To suit Sports Bars

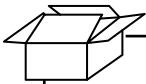
*Check contents of kit before commencing fitment and report any discrepancies*



\*Image example shown only

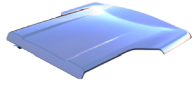
|                          |  |   |  |
|--------------------------|--|---|--|
| <b>IMPORTANT</b>         | <ul style="list-style-type: none"> <li>• Do not stand/sit or rest heavy objects on Tonneau Cover</li> <li>• Humans or animals are not to be under the closed Tonneau at any given time</li> <li>• Securely lock tonneau Cover before operating vehicle</li> <li>• Tonneau Cover is not dust or water tight</li> <li>• Do not carry open volatile chemicals with Tonneau Cover installed</li> <li>• If contact with volatile chemicals occur, clean Tonneau with mild detergent and water solution</li> </ul> |   |  |
| <b>Care Instructions</b> | <ul style="list-style-type: none"> <li>• Read Instructions fully before commencing installation.</li> <li>• Clean Tonneau Cover with a mild detergent and water solution</li> <li>• Do not use abrasive cleaners or solvents</li> <li>• Refer to manufactures instructions applicable to power drill.</li> <li>• Protect Tub floor against scratches during installation process.</li> </ul>   |   |  |
| <b>Maintenance</b>       | <p>If lubrication of the locks or hinges is required use only Graphite Powder. DO NOT use any other lubricants or oils.</p>  |   |  |
| <b>Tools Required</b>    | <ul style="list-style-type: none"> <li>• Pen / Marker</li> <li>• Centre Punch</li> <li>• Drill &amp; Drill bits</li> <li>• Phillips head screwdriver</li> <li>• Caulking Gun</li> <li>• Silicon - Non Acetic</li> </ul>  | <ul style="list-style-type: none"> <li>• Die Grinder &amp; multi tool</li> <li>• Masking Tape</li> <li>• Scissors &amp; Knife</li> <li>• Ruler</li> <li>• Spanner &amp; Socket</li> <li>• Tape measure</li> </ul> | <ul style="list-style-type: none"> <li>• Soapy water solution</li> <li>• Allen Key set (Metric)</li> </ul> |

## PARTS CHECK SHEET



### PARTS IN MAIN CARTON

1



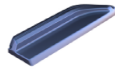
Tonneau Cover  
Qty - 1

2



LHS Infill  
Panel  
Qty - 1

3



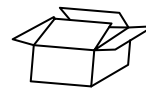
RHS Infill  
Panel  
Qty - 1

4

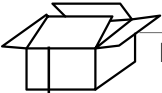


Lock Keys  
(Attached to  
Tonneau rotary  
latch) Qty - 2

5



Fitting Kit  
Qty - 1



### PARTS IN FITTING KIT

1186



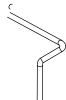
Lid HInge  
Qty - 2

1177



Hinge Bracket  
Qty - 2

1177



Hinge Pin  
Qty - 2

S700-220



Gas Strut  
Qty - 2

1040



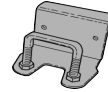
Strut body mount  
Qty - 2

UB



Striker U-Bolt  
Qty - 2

1189

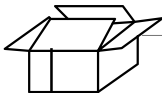


Striker  
Bracket  
Qty - 2

1200



Brace bracket  
Qty - 2



### LID NUTS AND BOLTS

25



M8x25 ALAN  
Head Bolt  
Qty - 8

24



M8 3mm thick  
Flat Washer  
Qty - 8

19



Self drilling screws  
Qty - 18

23



M8  
Hex Nut  
Qty - 8

1

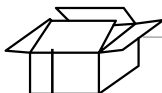


M6 12MM Bolt  
Qty - 2

15



M6 Lock Nut  
Qty - 2



### SPORTSBAR NUT AND BOLTS

11



M6 WASHER  
Qty - 4

13

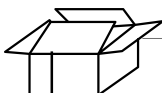


M6 SPRING WASHER  
Qty - 4

18



M6 40MM BOLT  
Qty - 4



### OTHER

42



Alan key

Qty - 1



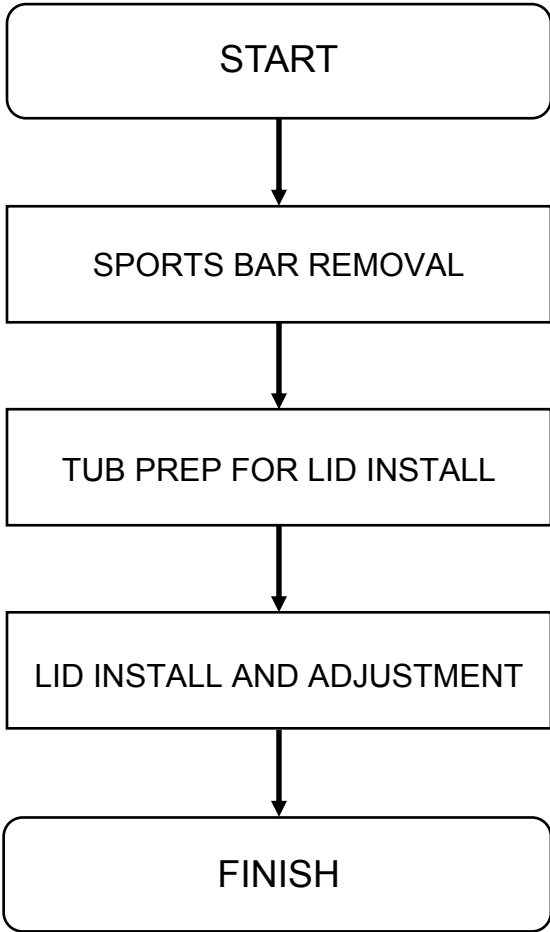
Alcohol wipe

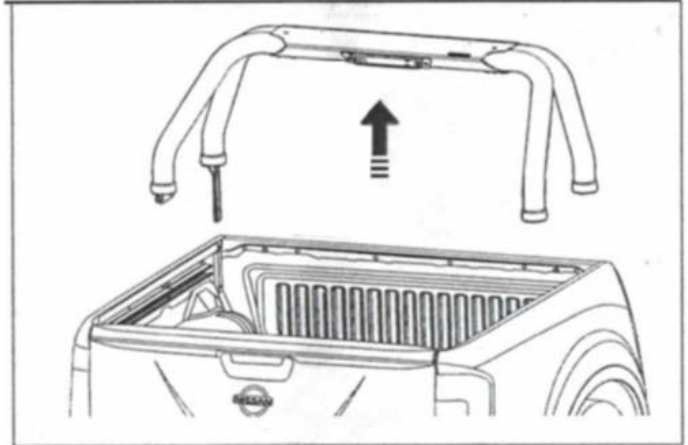
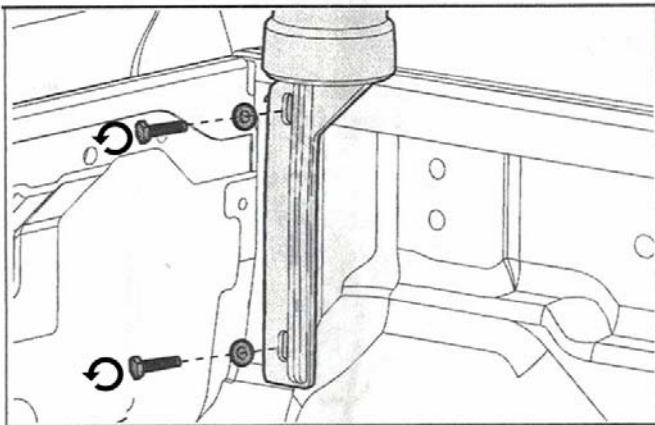
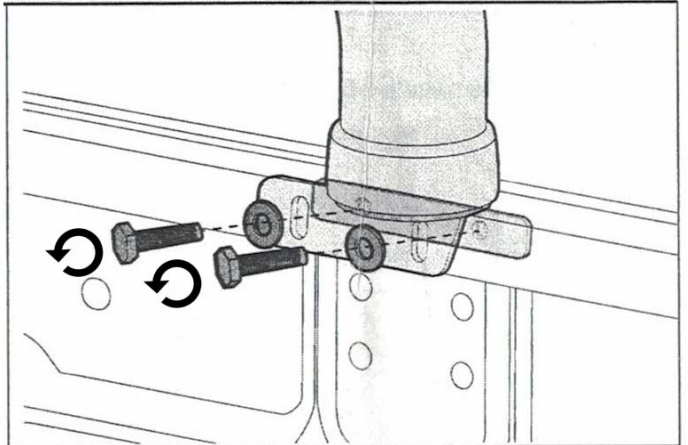
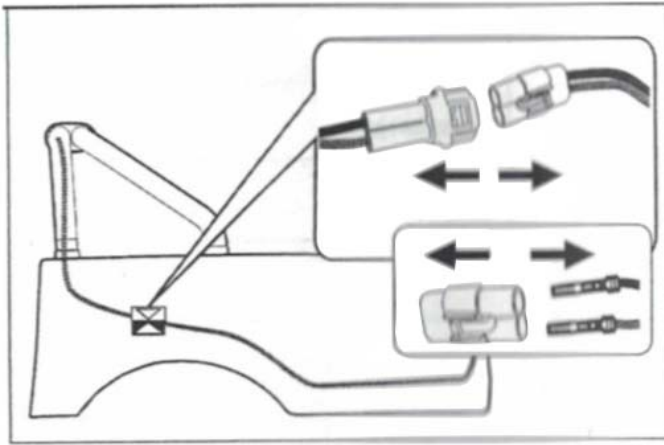
Qty - 1



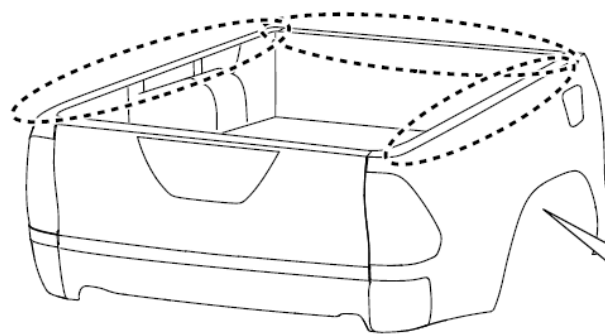
Fitting  
Instruction  
Qty - 1

# Installation Steps Flow Chart



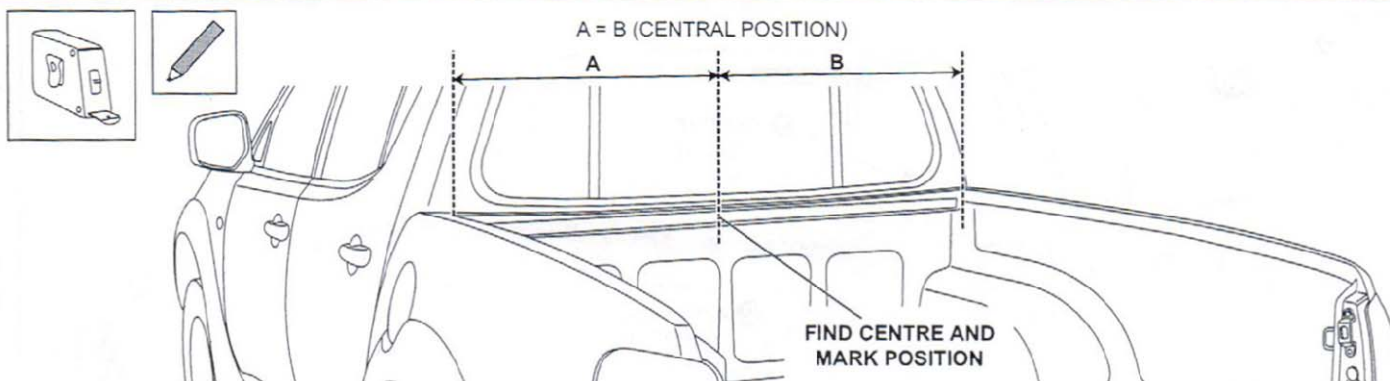


Remove Sports Bar from vehicle and retain all hardware.



Thoroughly clean installation areas. Lay a sheet inside the tub to catch metal drill swarf from installation.

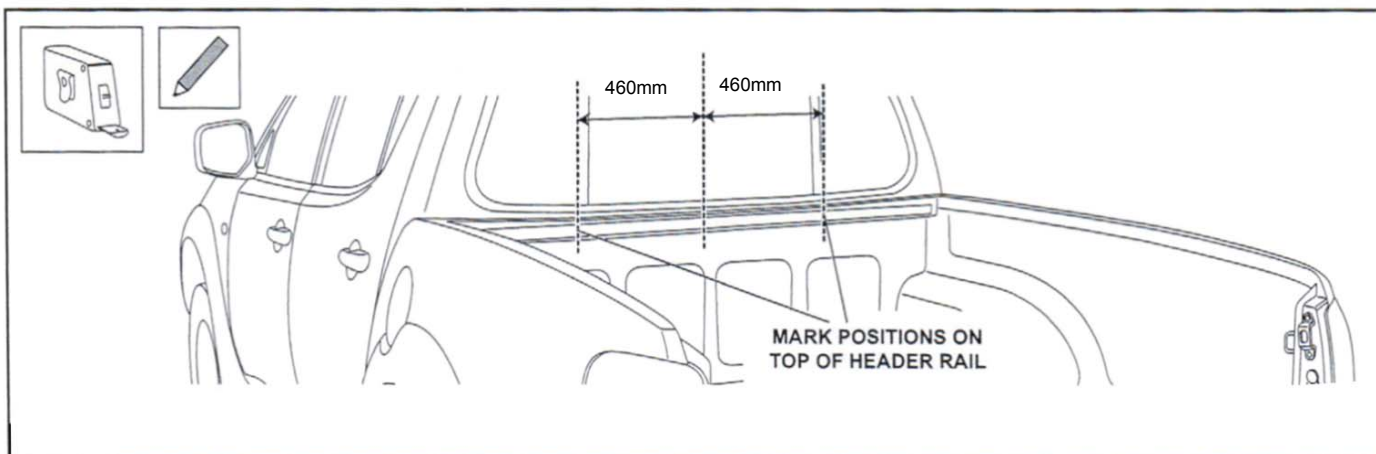




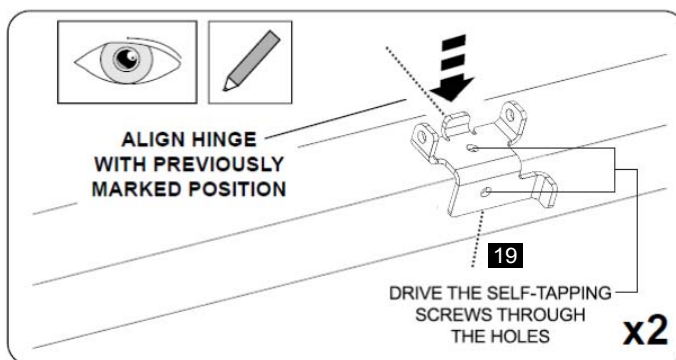
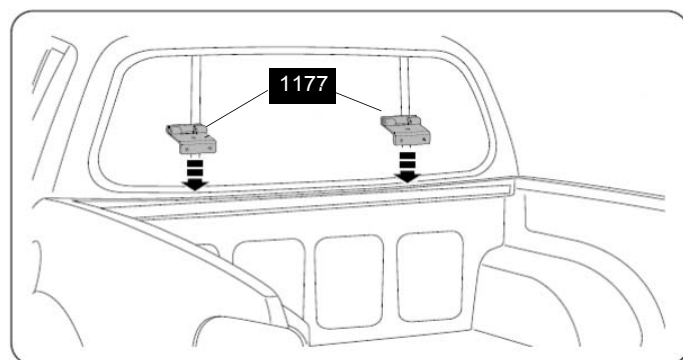
Find the centre of the bed and mark the position.

### Hinge mounts:

Align the hinge mounts along front of tray, ensuring the hinges are properly positioned from centre of tub **460mm** to centre of hinge mount either side along the inside of the front of tub. Attach the hinges using self-drilling screws (supplied) through holes pre-drilled into the hinges. Apply clear or black silicone to any gaps and between the hinges and the vehicle to prevent water entry.



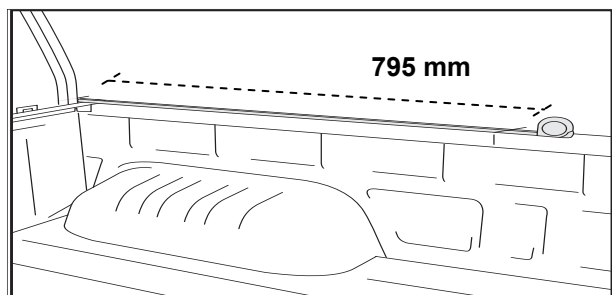
Measure and mark the positions as indicated above from the centre of the bed for placement of the bottom hinges.  
**WARNING: RECHECK DIMENSIONS TO ENSURE CORRECT MEASUREMENT**



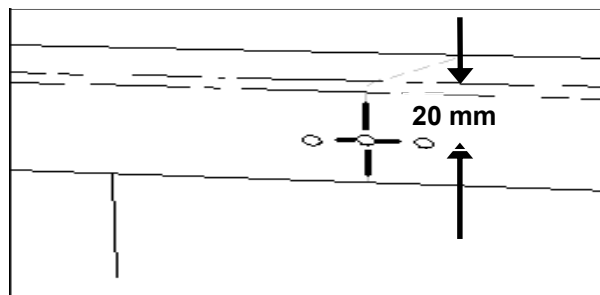
Drive the self-tapping screws through the holes in the top and the base of the hinge plate into the tub. Tighten to 3Nm.

### Gas Struts:

Measure from the front rail inside of tub, measure along top edge of tray **795 mm** (windscreen end) then down **20mm** and mark the screws position for the gas strut bracket. Position the gas strut bracket accordingly, mark two mounting holes and centre. **Refer to Fig. 1 and Fig. 2**

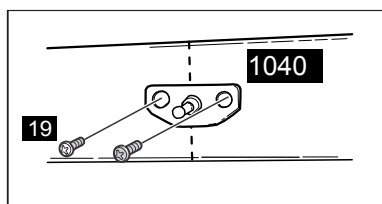


**Fig.1 - Gas strut bracket location**



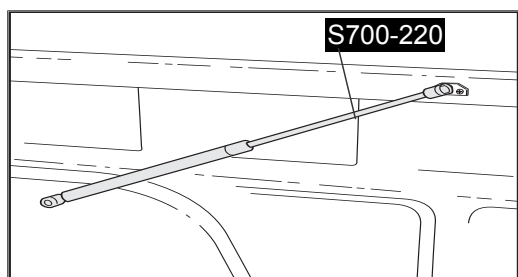
**Fig.2 - Gas strut bracket location**

Using a **2 mm** diameter drill bit set to **5 mm** drill stop. Drill two pilot holes. Attach small gas strut bracket using self drilling screws provided. Repeat process on other side of tray. **Refer to Fig. 2 and Fig.3**



**Fig.3 - Gas strut bracket fitment**

Attach small shaft end of gas strut onto gas strut brackets, by clicking them in place. **Refer to Fig.4 with regard to gas strut orientation.**



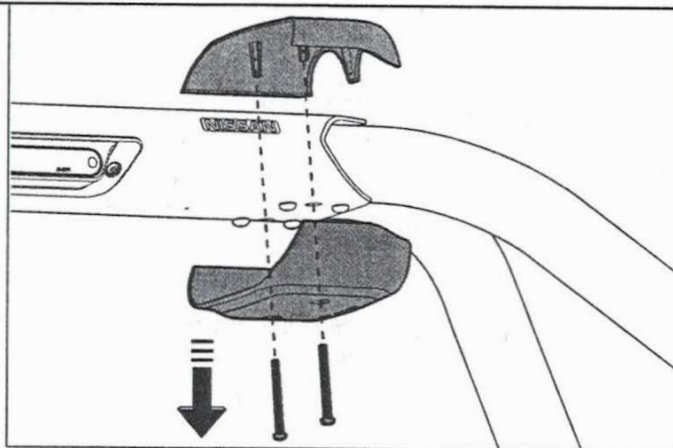
**Fig.4 - Gas strut orientation**

Clean header rail (where extrusion will sit) with alcohol wipes provided and wipe away residue with a dry clean cloth. Place the extrusion tape seal along the top of the header rail with the sealing lip facing towards the tailgate. Start the extrusion before the infill ends and run behind the hinges. **IMPORTANT:** Position extrusion as close to the header rail rear radius. Rub down firmly to ensure maximum adhesion.

**Important:**  
**DO NOT over tighten screws. Recommended tightening torque is 1- 3 Nm**

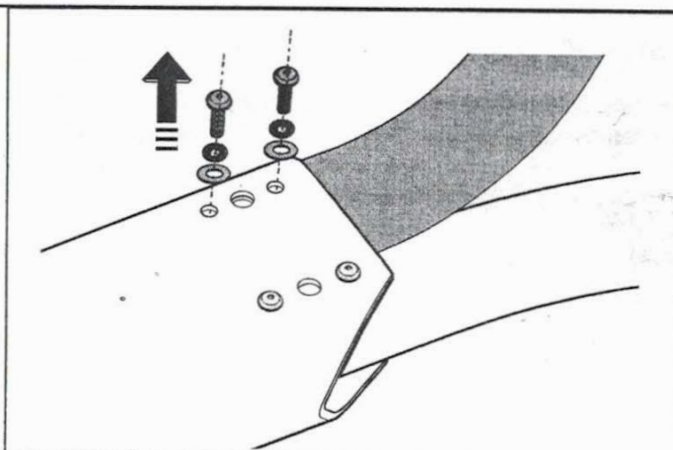
Note: Do this step only if Sports Bar is fitted.

- On the Sports Bar remove the top and bottom RH plastic covers, by removing the 2x 5x75mm Screws.
- Repeat for LHS.
- Keep all the hardware.



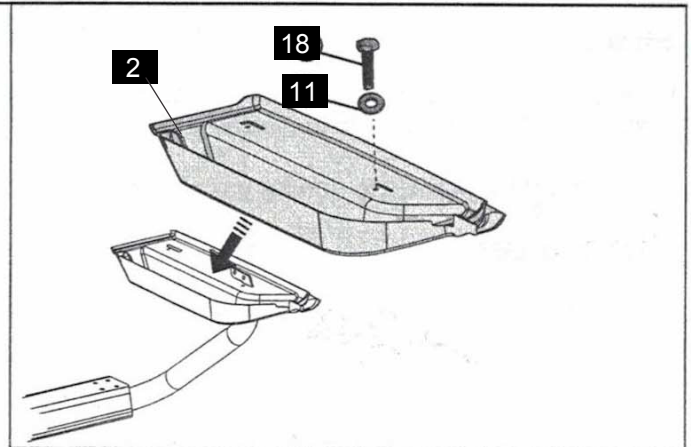
Note: Do this step only if Sports Bar is fitted.

- Remove the front sports bar RHS tube by removing 2x M8x 25mm Screws and 2x M8 Internal Lock Washers and 2x Large M8 Flat Washers.
- Repeat on LHS with the Front Tube.
- Keep all the hardware.



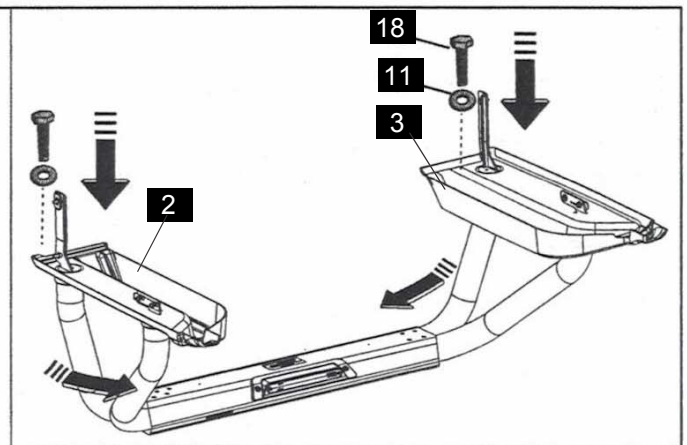
Note: If not fitted, assemble Sports Bar as per instructions, do not fit front legs.

- Install the LHS infill panel (2) to the rear LHS sports bar leg using the M6x30 (18) hex head screw and M6 flat washer (11).
- Do not tighten at this point to allow adjustment once placed on the tub.
- Repeat for RHS.

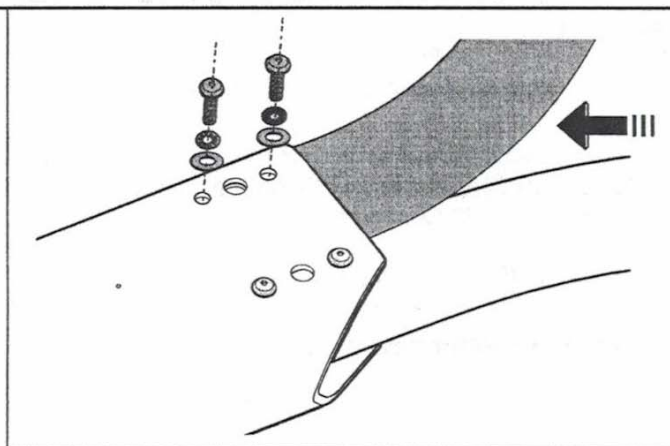


- Feed the Sports Bar CHMSL loom through the front infill panel slot (LHS only).
- Install the LHS infill panel (2) to the front LHS sports bar leg using the M6x30 (18) hex head screw and M6 flat washer (11).
- Slide the front sports bar legs into the centre extrusion. Do not tighten at this point.
- Repeat for RHS.

Note: Two people will be required to assemble the bars.

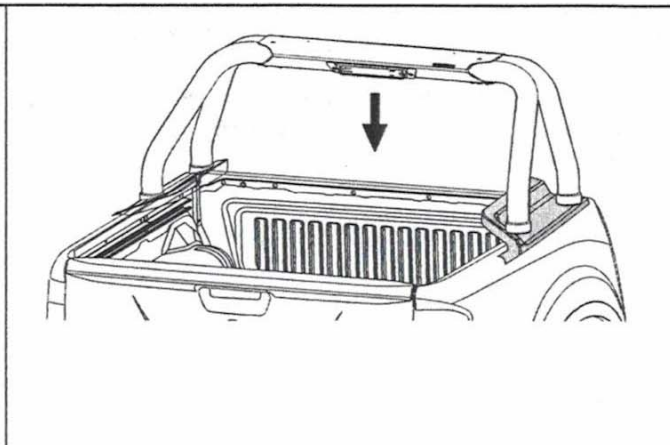


- Secure the front sports bar legs with the previously removed hardware.
- Do not fully tighten.

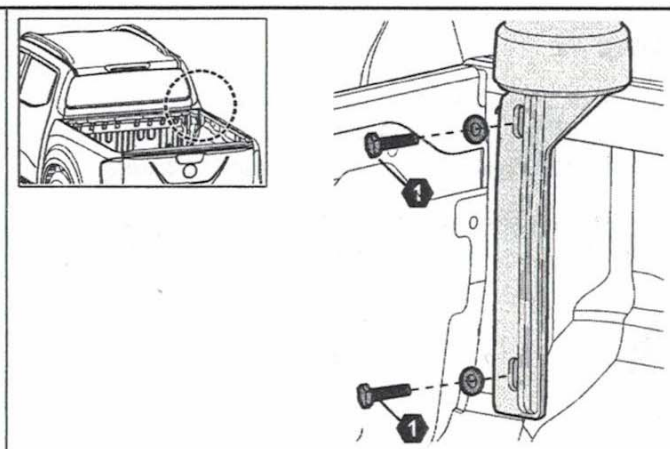


- Reinstall the Sports Bar to the vehicle using previously removed hardware.

Note: Two people will be required to lift sports bar onto vehicle.

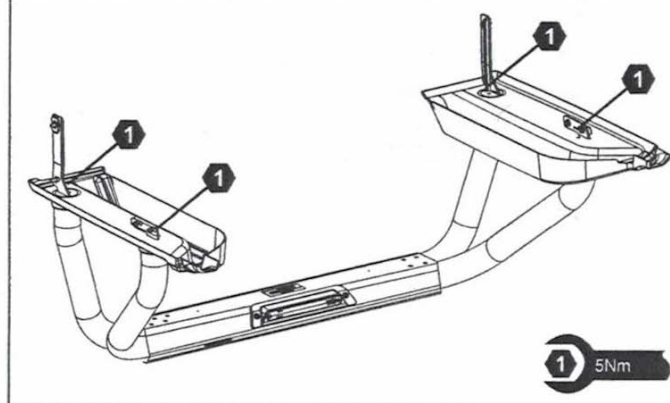


- Refit the two M8 bolts securing the front RHS leg of the sports bar to the vehicle tub.
- Use medium strength thread locker.
- Repeat for LHS.



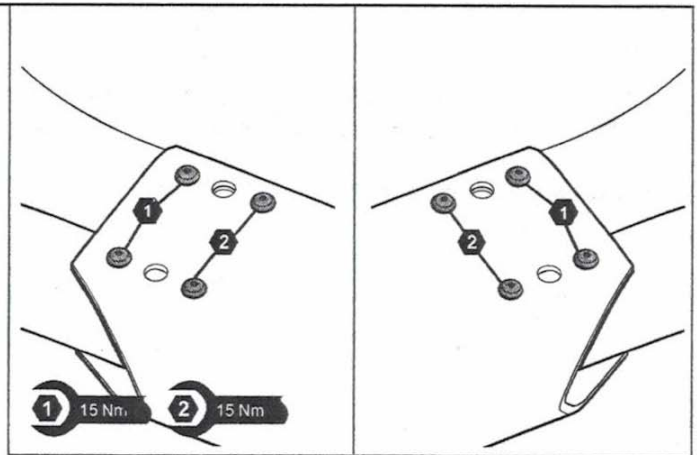
- Check infill panel clearances between trim edges and tub sheet metal. Gaps should be consistent for LH and RH sides. If not adjustment is required.
- Tighten the four M6 screws securing infill panels to the sports bar legs.

IMAGE ROTATED AND TUB REMOVED FOR CLARITY

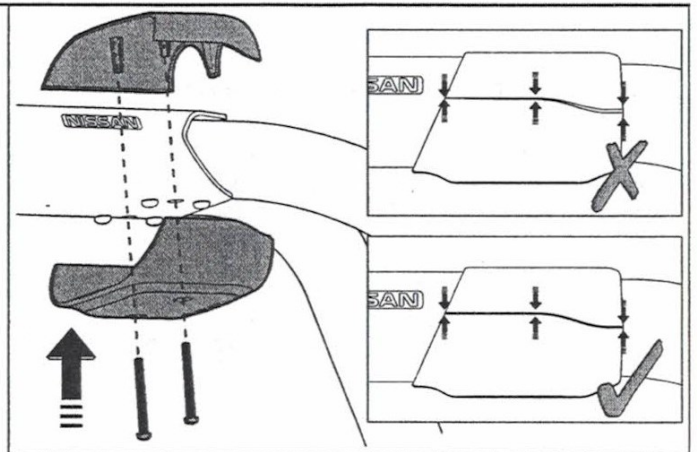




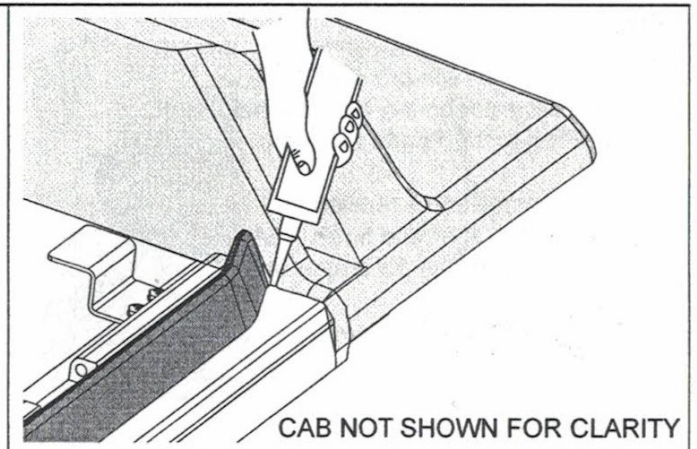
- Fully tighten all 4x outboard tube to centre extrusion bolts (2 on LHS 2 on RHS of Sports Bar) to 15Nm.
- Fully tighten the remaining 4x tube to centre extrusion bolts to 15Nm.



- Install the top and bottom plastic covers and fasten with the 2x 5x75mm Screws.
- Tighten the screws until the top and bottom cover gapping is consistent. Do not over-tighten. Do not use power tools.
- Make sure that the parts are aligned and that the gap is even around the plastics. The gapping can be adjusted by tightening or loosening the screws.
- Repeat for LHS.

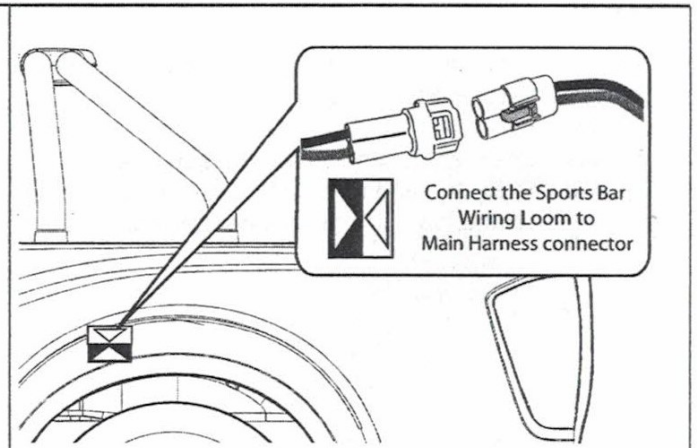


- Apply a bead of silicon (non-acetic, not supplied) to the gap between the rubber seal and infill panel as shown.
- Repeat for RHS.

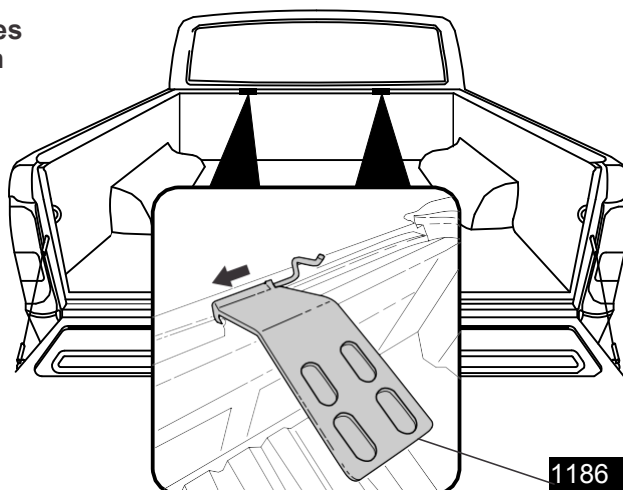


- Connect the 2-way connector on the Main Harness to the sports Bar extension loom in the wheel arch well.

Note: If Sports Bar not fitted, refer to the wiring in the Sports Bar Fitting Instruction.



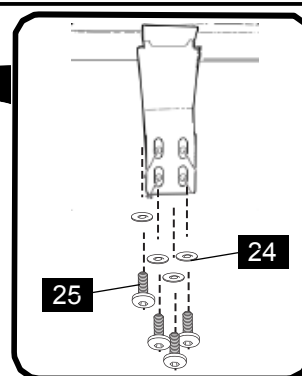
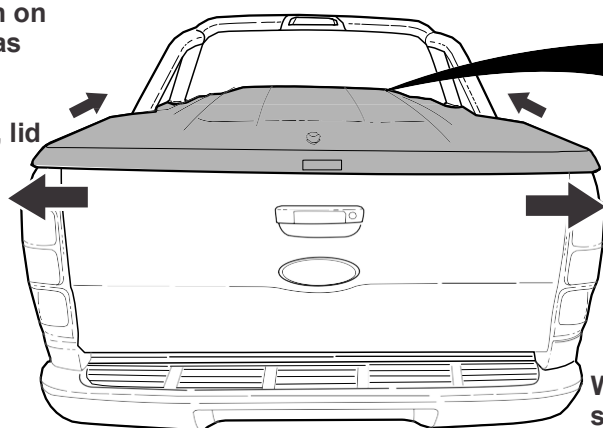
Attach lid hinges to tub hinges  
by aligning and pushing pin  
through.  
Click pin down into hinge  
locking tab



1186

Fit the lid and adjust so it is even on  
both sides and forward as far as  
possible while staying level.

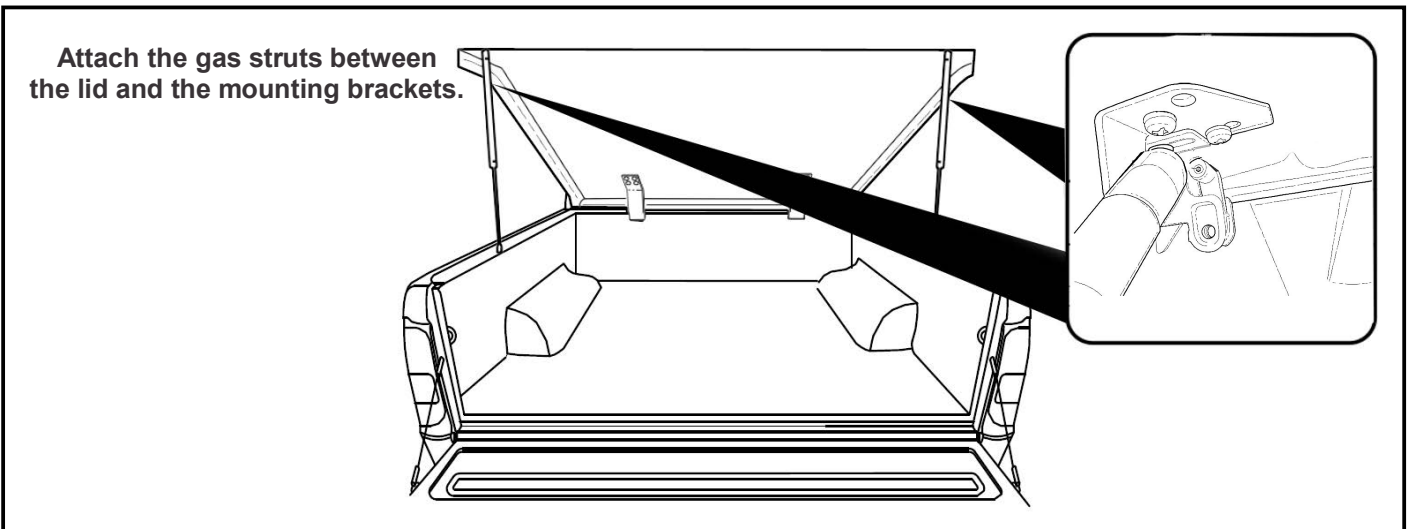
Note: When gas struts are fitted, lid  
will be pulled back slightly.



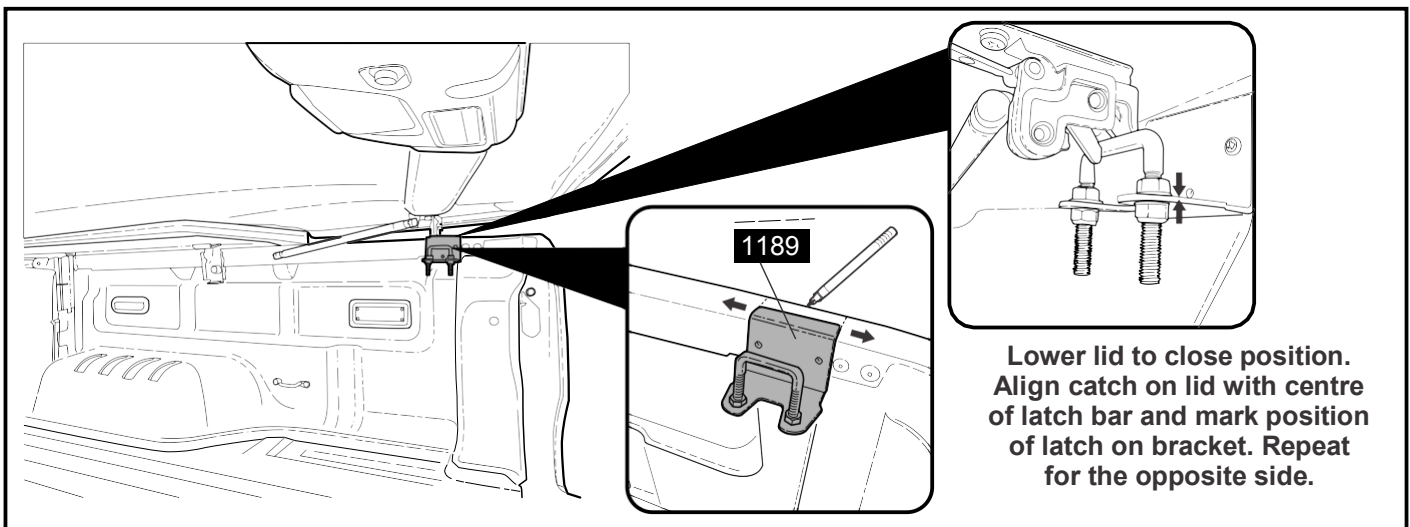
When lid is aligned correctly,  
secure the catch hinge to the  
lid using 4 M8 Thick  
Washers and M8 Bolts

**Important:**  
Ensure tongues are fully inserted into the hinge slots with hinge pin securely in place.

With the Hard Tonneau Cover opened, attach the cylinder end of each gas strut onto the mounting brackets attached to the Hard Tonneau Cover by clicking into place  
**Refer to Fig. 9**



**Fig. 9 - Attach gas strut**



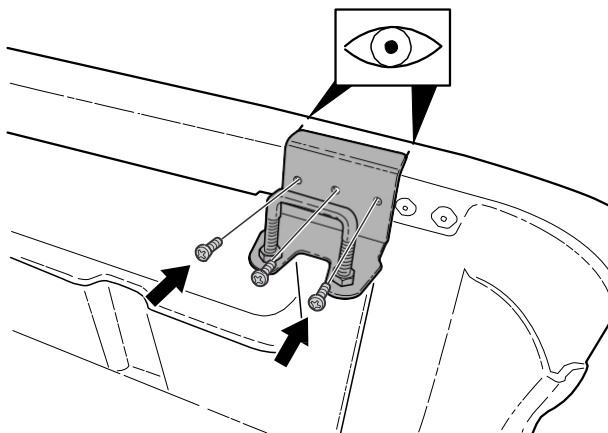
**Important:**

**If you have purchased a Central Locking Ute Lid please ignore the next page concerning Lock Bracket Installation and Lock Bracket adjustment.**



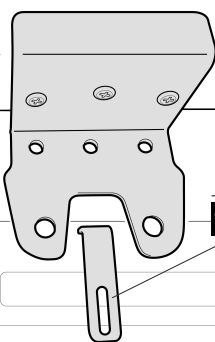
Fasten latch bracket  
in place with self-tapping  
screws.

Repeat for the opposite  
side.



Part No: 19  
Self Tapping  
Screws

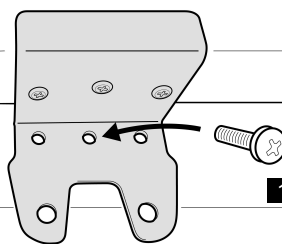
1



1200

Choose relevant hole to  
avoid obstruction.

2

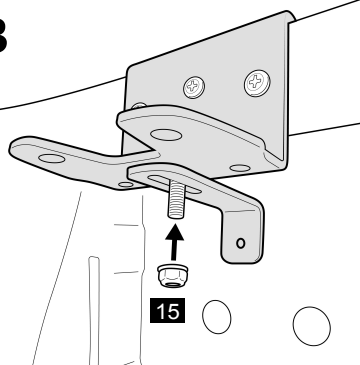


1



Part No: 1200  
Brace Bracket

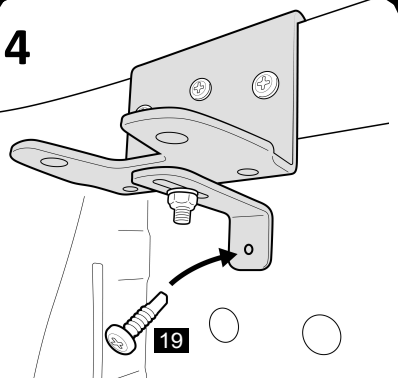
3



15

Tighten loosely

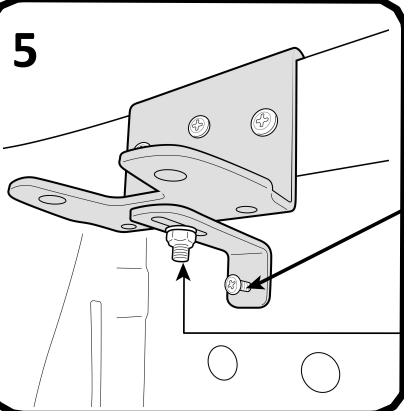
4



19

Align brace bracket against  
tub inner wall.

5



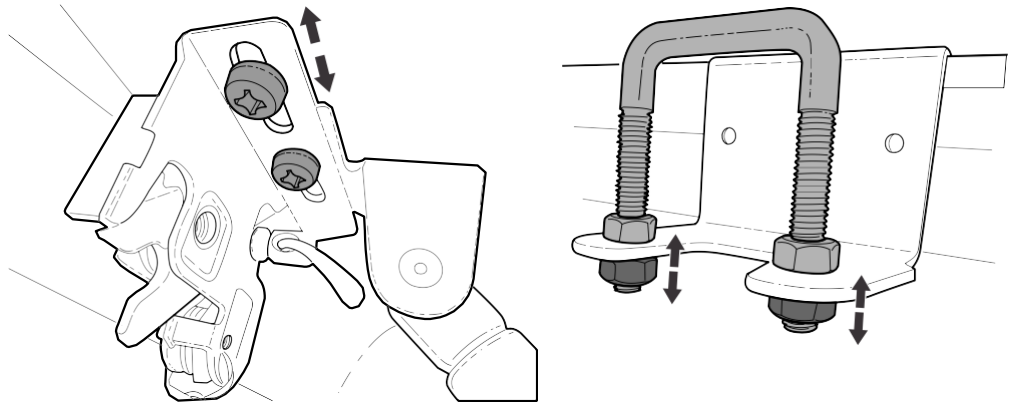
1) Screw in using self drilling screw

2) Tighten fully

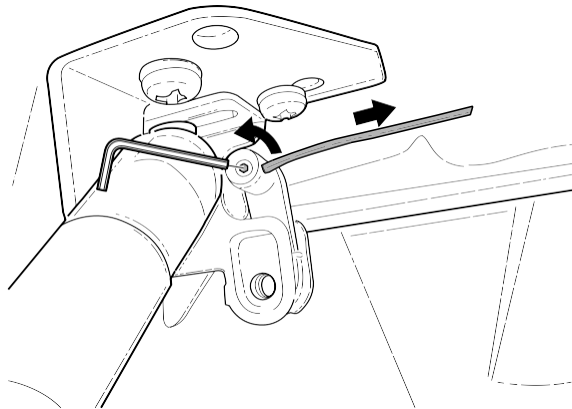
Loosen 2 screws and slide catch to align correctly with latch bar. Tighten screws to secure in place.

Adjust nuts on latch bar to alter height of bar to suit.

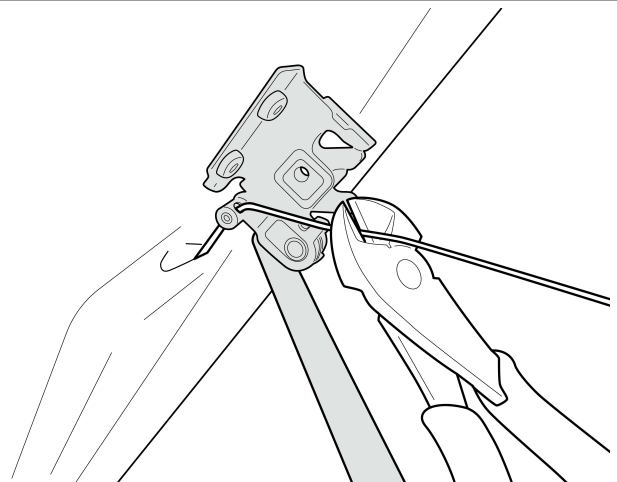
Repeat for the opposite side.

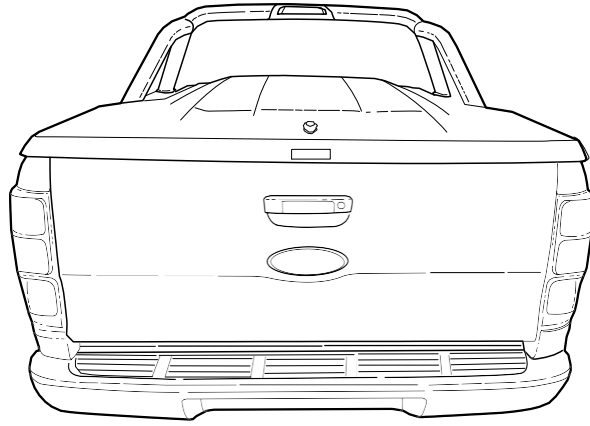


Use an Allen key to loosen the hex key screw on the catch and tension cable so it is tight but doesn't move the catch at all, then re-tighten the hex key screw.



Cut off excess cable making sure to leave 20mm from locking allen key bolt.





## REMOVAL OF TONNEAU COVER

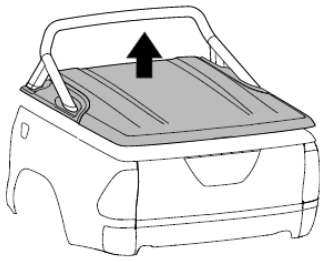


FIGURE 1

1. Open tonneau cover. Disconnect harness at front Header bar. Detach gas strut (1) by inserting a small screwdriver and adjusting the spring clip (2) on the gas strut(1). Refer to figure 2.

**NOTE:** Do not remove the spring clip, only a small amount of levering is required to detach.

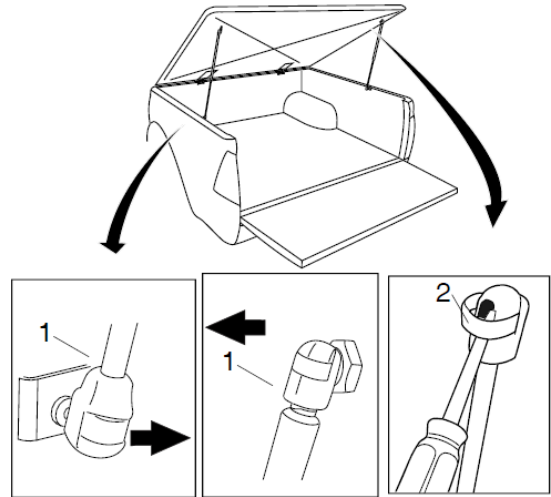


FIGURE 2

**NOTE:** 2 people are required to lift and remove the tonneau cover from the vehicle.

2. Remove hinge pins (1) and remove tonneau cover (2). Refer to figure 3.

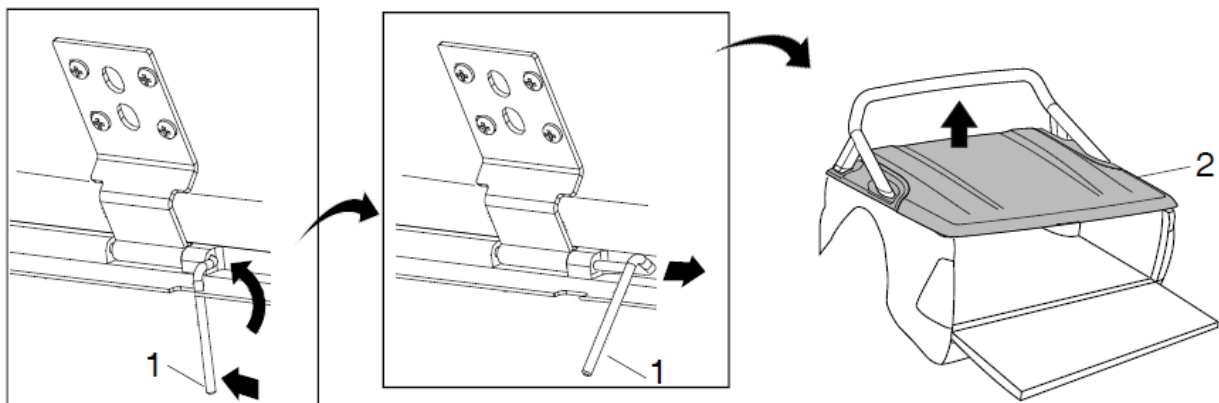


FIGURE 3

## REPLACEMENT OF TONNEAU COVER

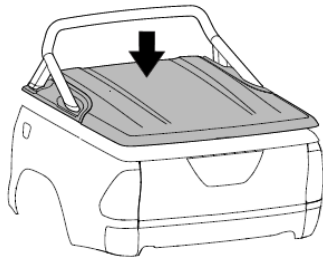


FIGURE 4

NOTE: 2 people are required to lift and fit the tonneau cover onto the vehicle.

1. Fit tonneau cover (2) and secure hinges with hinge pins (1). Refer to figure 5.

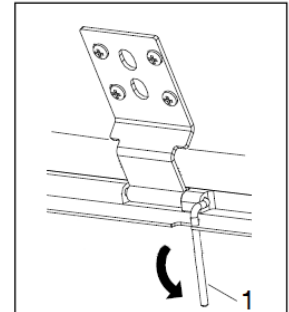
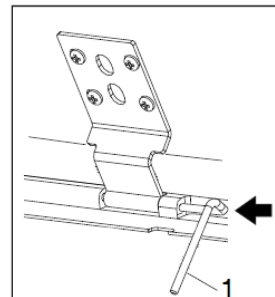
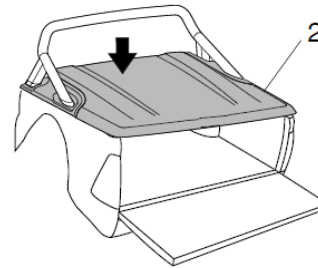


FIGURE 5

2. Attach gas struts (2) by clipping into place. Ensure narrow end (1) mounts to the vehicle. Reconnect harness at front header bar. Refer to figure 6.

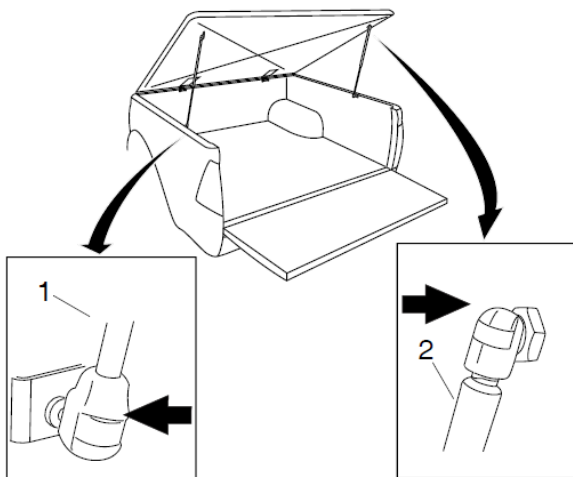


FIGURE 6

### Paint care instructions:

Your new painted Hard Tonneau Cover has been covered with a plastic film to protect the paint from damage. It will require cleaning and possibly light polishing after the protective film has been removed. Use polish as per new paint on a new vehicle. Wash Hard Tonneau Cover using water and normal carwash detergent and polish with an automotive polish.

**NOTE: Please ensure Lid is kept locked at all times when not being used, for both safety and longevity.**

**Having trouble? Call your Supplier.**





# NP15P

## Nissan NP300 Navara Dual Cab



| NP15P                            | LID         |                 |       |
|----------------------------------|-------------|-----------------|-------|
| PART DISCIPTION                  | PART NUMBER | QUANTITY/LENGTH | CHECK |
| LID FRONT HINGES                 | 1186        | 2               |       |
| LID TUB MOUNTS WITH PINS         | 1177        | 2               |       |
| GAS STRUT BODY MOUNTS            | S700-220    | 2               |       |
| STRUT BODY MOUNTS                | 1040        | 2               |       |
| M8 U BOLT                        | UB          | 2               |       |
| LOCK STRICKER BRACKET            | 1189        | 2               |       |
| BRACE BRACKET                    | 1200        | 2               |       |
|                                  |             |                 |       |
|                                  |             |                 |       |
| <b>LID NUTS AND BOLTS</b>        |             |                 |       |
| M8 BOLTS                         | 25          | 8               |       |
| M8 WASHER (3MM THICK)            | 24          | 8               |       |
| SELF DRILL SCREWS                | 19          | 18              |       |
| M8 NUTS                          | 23          | 8               |       |
| M6 12MM BOLT                     | 1           | 2               |       |
| M6 LOCK NUT                      | 15          | 2               |       |
|                                  |             |                 |       |
| <b>SPORTS BAR NUTS AND BOLTS</b> |             |                 |       |
| M6 WASHER                        | 11          | 4               |       |
| M6 SPRING WASHER                 | 13          | 4               |       |
| M6 40MM BOLTS                    | 18          | 4               |       |
|                                  |             |                 |       |
|                                  |             |                 |       |
| <b>OTHER</b>                     |             |                 |       |
| Allen Key                        | 42          | 1               |       |
| ALCOHOL WIPE                     |             | 1               |       |
| FITTING INSTRUCTION MANUAL       |             | 1               |       |