



WWW.HSPUTELIDS.COM

Part No: MX4R

Fitting Time: 180 minutes

ROLL.Я.COVER

To suit Mercedes X Class Dual Cab 2018+

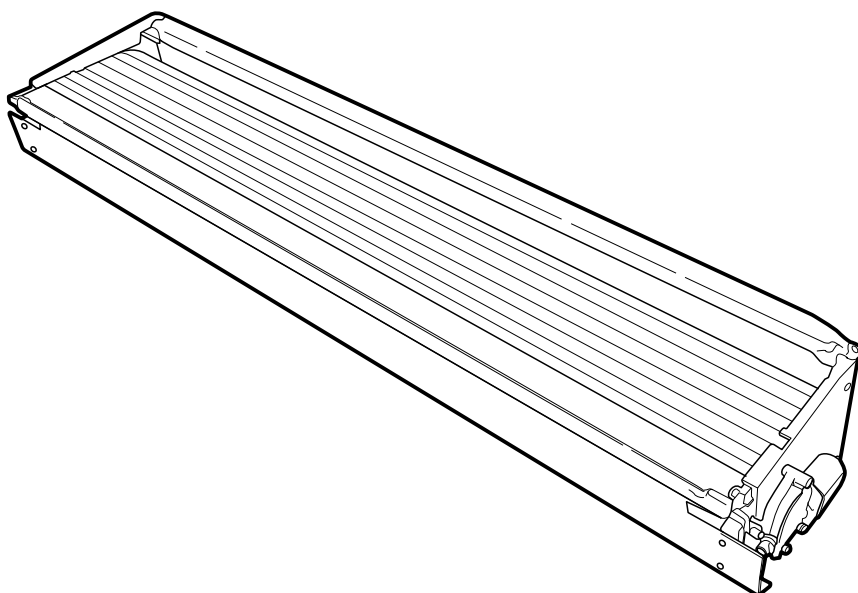

Roll-R-Cover

Fitting Instructions

— General Notes —

- Read through the fitting instructions before installation of accessory.
- Always install the Roll R Cover Wiring Kit following the workshop manual and fitting instructions provided. Failure to do so may cause damage to the vehicle or the accessory.
- Ensure all recyclable components and packaging are discarded and recycled following local recycling regulations.
- It is always recommended that the Roll R Cover Wiring Kit is fitted by a qualified automotive technician.
- Safely store and protect any removed vehicle components.

— Safety Notes —

- Check that all work practices comply with safety standards.
- Please wear appropriate clothing and use safety equipment.



— Fitting Time —



180 minutes

— Parts Supplied —

MX4R		DUAL CAB MERCEDES BENZ XCLASS - ROLL R COVER		
PART DESCRIPTION	PART NUMBER	QUANTITY/LENGTH	CHECK	
MX4R FITTING INSTRUCTIONS	373*	1		
LUBRICANT PUMP SPRAY	47*	1		
REMOTE	215*	2		
PRIMER STICK	44*	1		
CABLE TIE 4.8X300MM	217*	10		
ROLL R LOOM	216*	1		
MX4R CANISTER AND CURTAIN	273*	1		
MX4R RAIL RIGHTHAND	315*	1		
MX4R RAIL LEFTHAND	316*	1		
HOSE 600MM	11*	4		
COMPLETE CANISTER COVER	401	1		
OPERATION LEAFLET	66	1		
MAINTENANCE LEAFLET	67	1		
ADJUSTMENT PLATES	31	2		
BLACK PUTTY	3*	8		

The following steps are for vehicles with bed liners.
If there are no bed liners installed move to Step 5

– Step 1

Trim front of bed liner by 180mm from the top of the ute bed as shown.

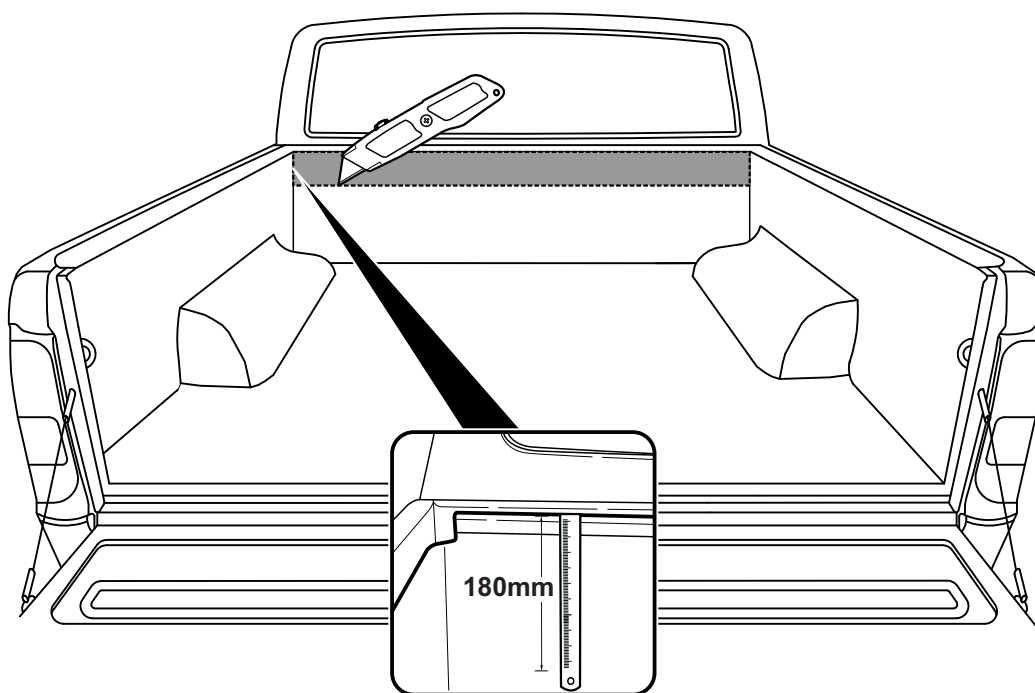

– Step 2

Cut a 20mm split for bed liner to flex.

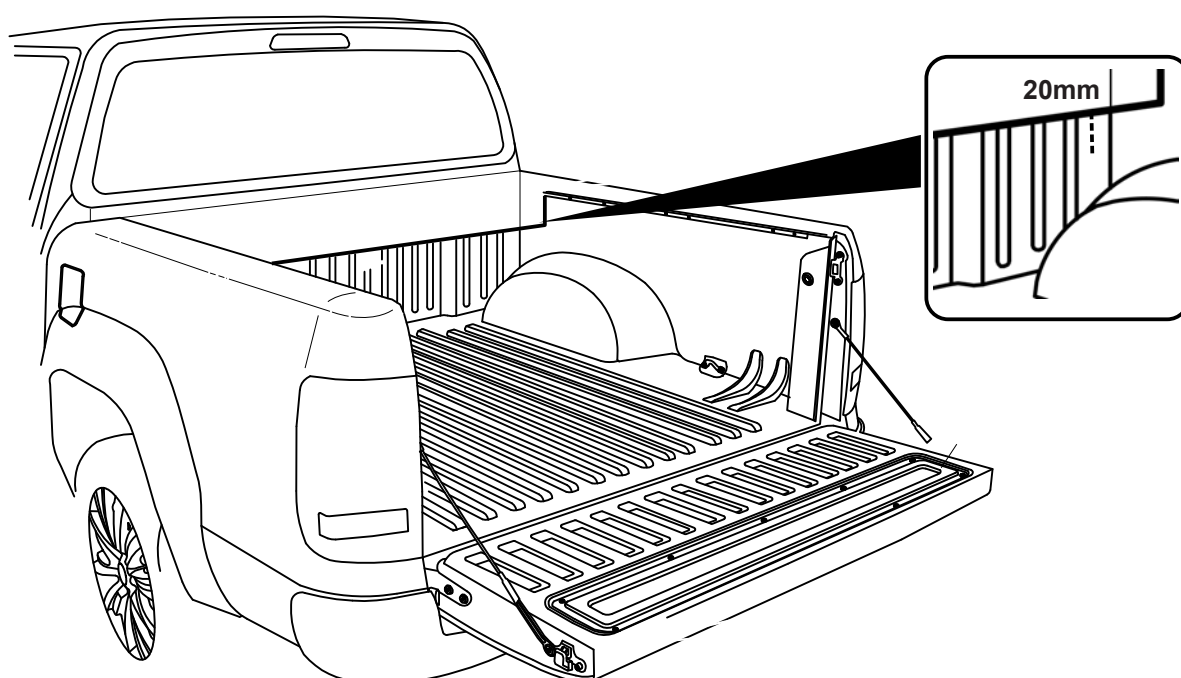

– Step 3

Measure 60mm from top of tub and trim liner.

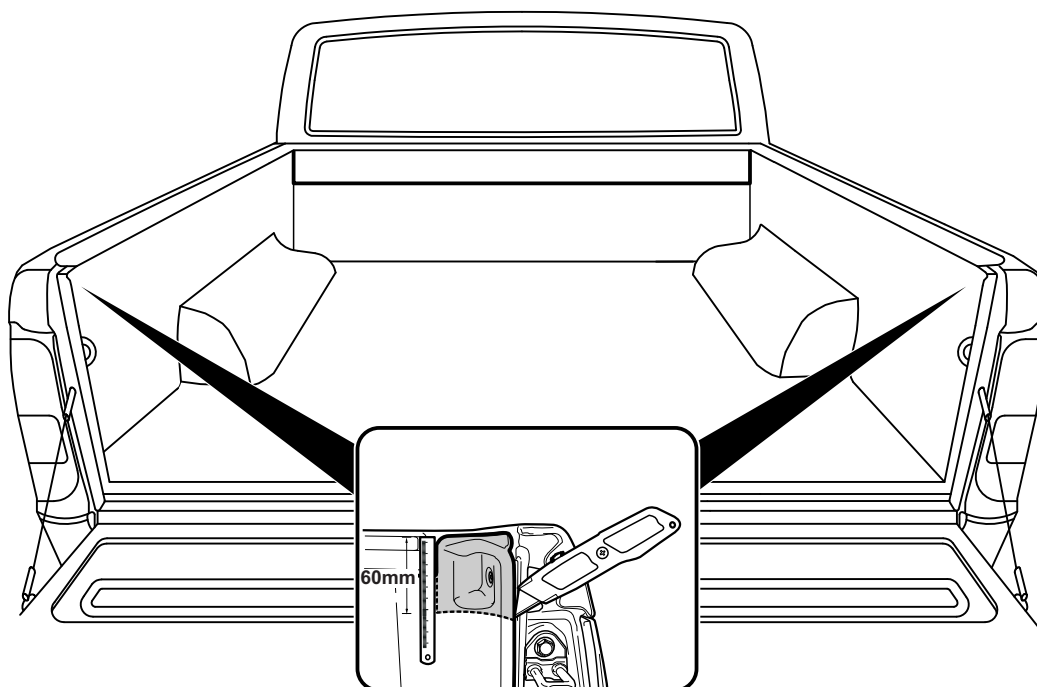

– Step 4

Measure 20mm down from top of tailgate and trim tailgate liner.

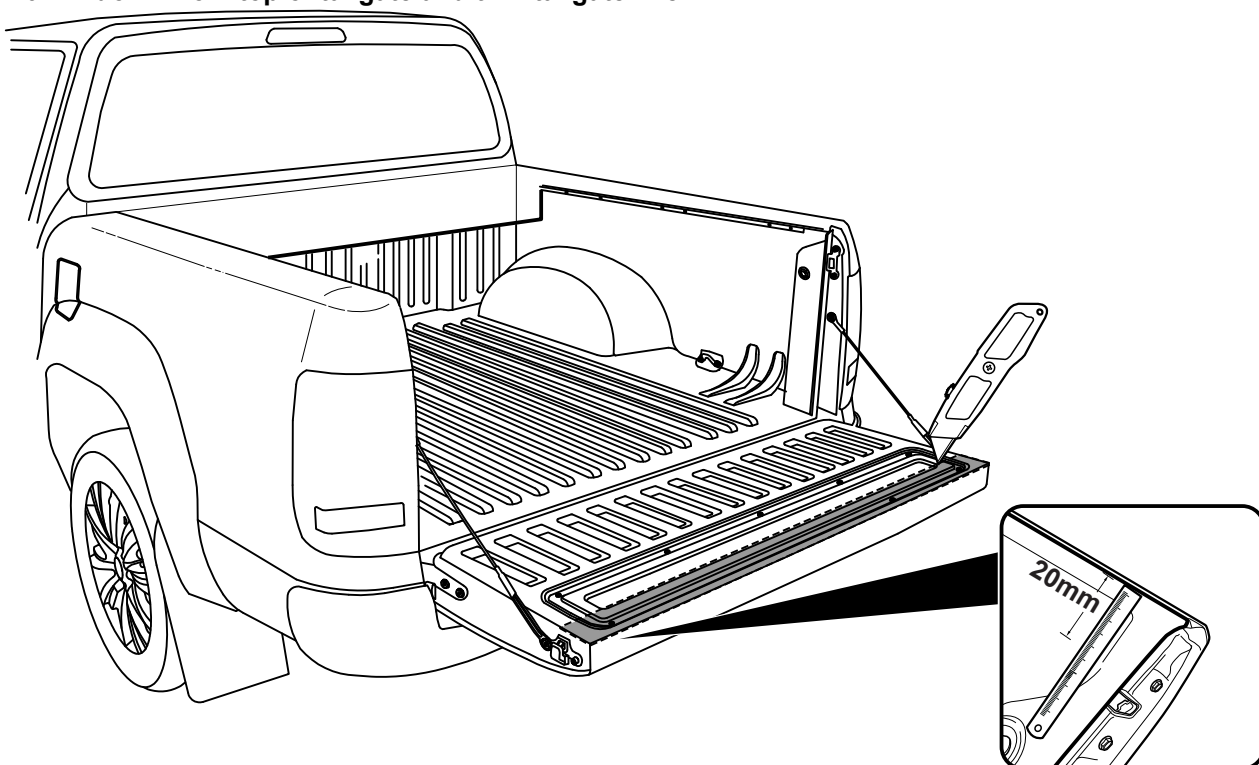

— Step 5 —

Roll-R-Cover preparation steps

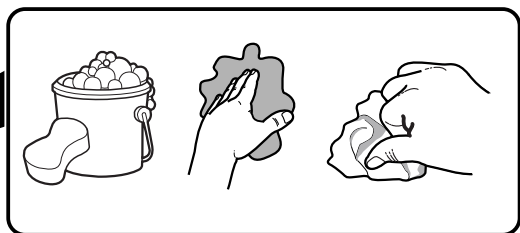

– Step 6

Carefully unpack the box.

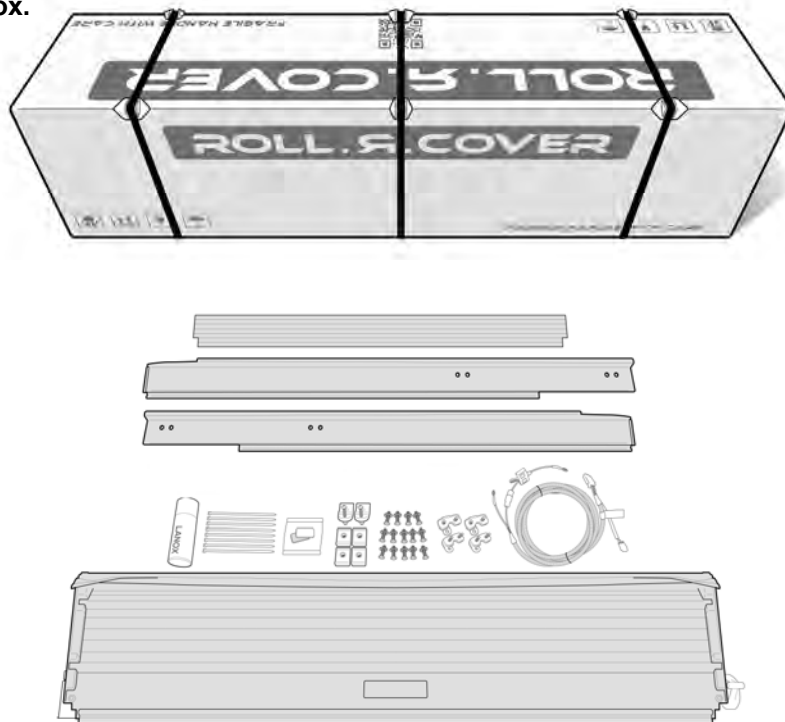

– Step 7

Wiring Harness steps

1 Feed through the cavity

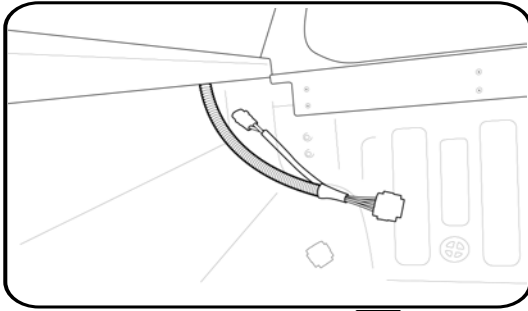

3

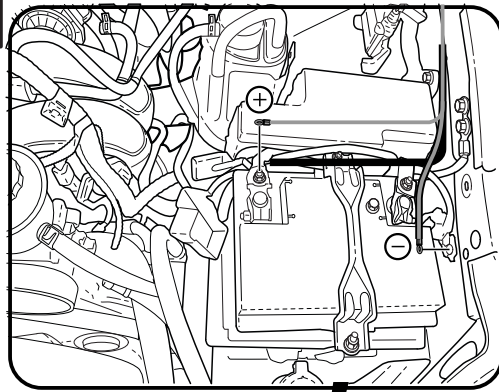

2

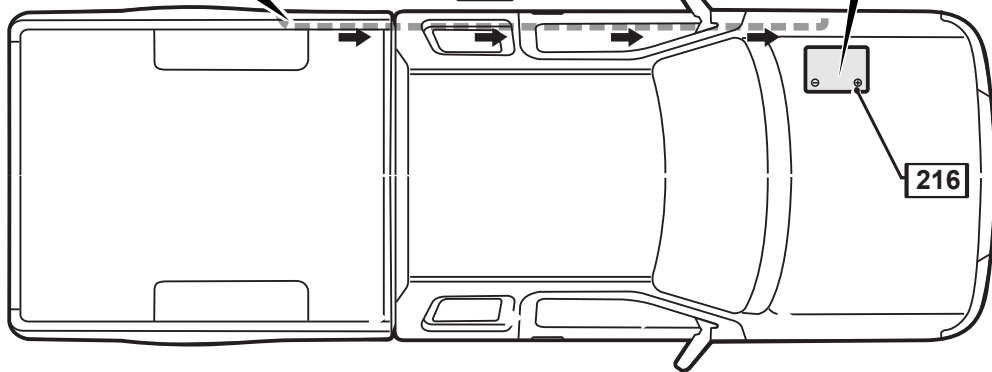

Run the wiring from the front corner cavity to the battery over the chassis rail. Making sure to keep away from hot obstructions and cable tie every 400mm.

– Step 8

Remove M8 Bolt &
M8 Spring Washer

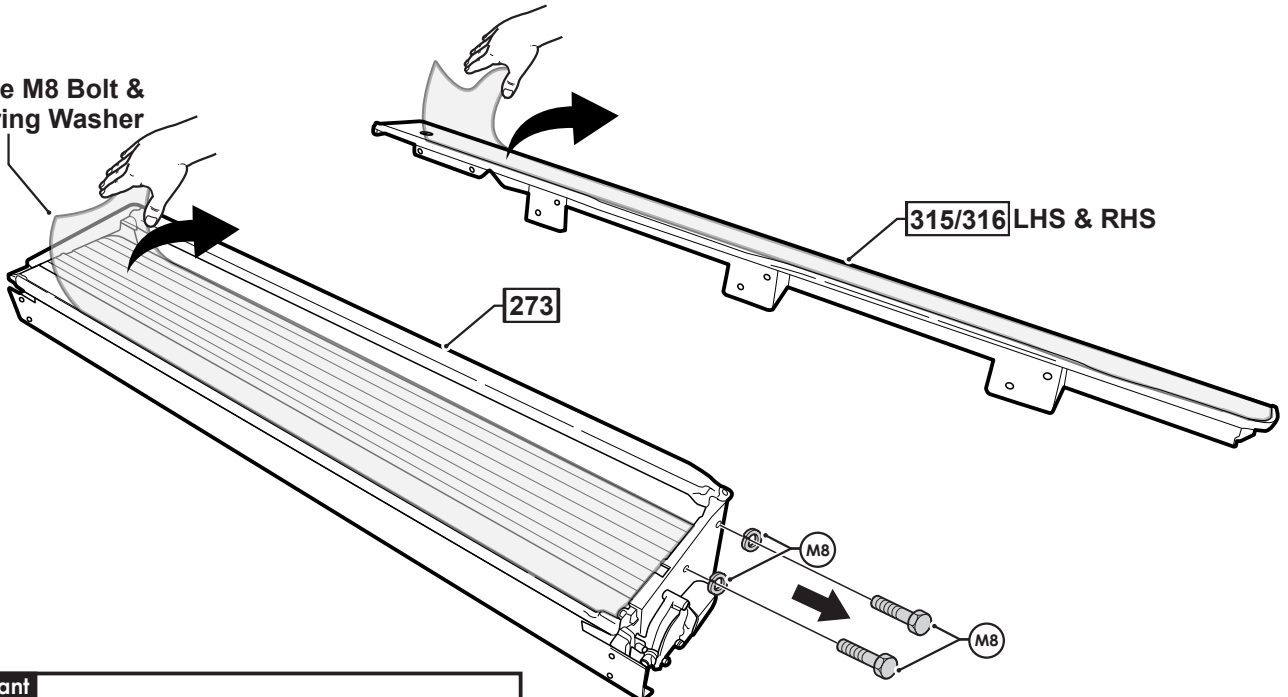

315/316 LHS & RHS

273

Important



Ensure the black tar is not removed with the film.

– Step 9

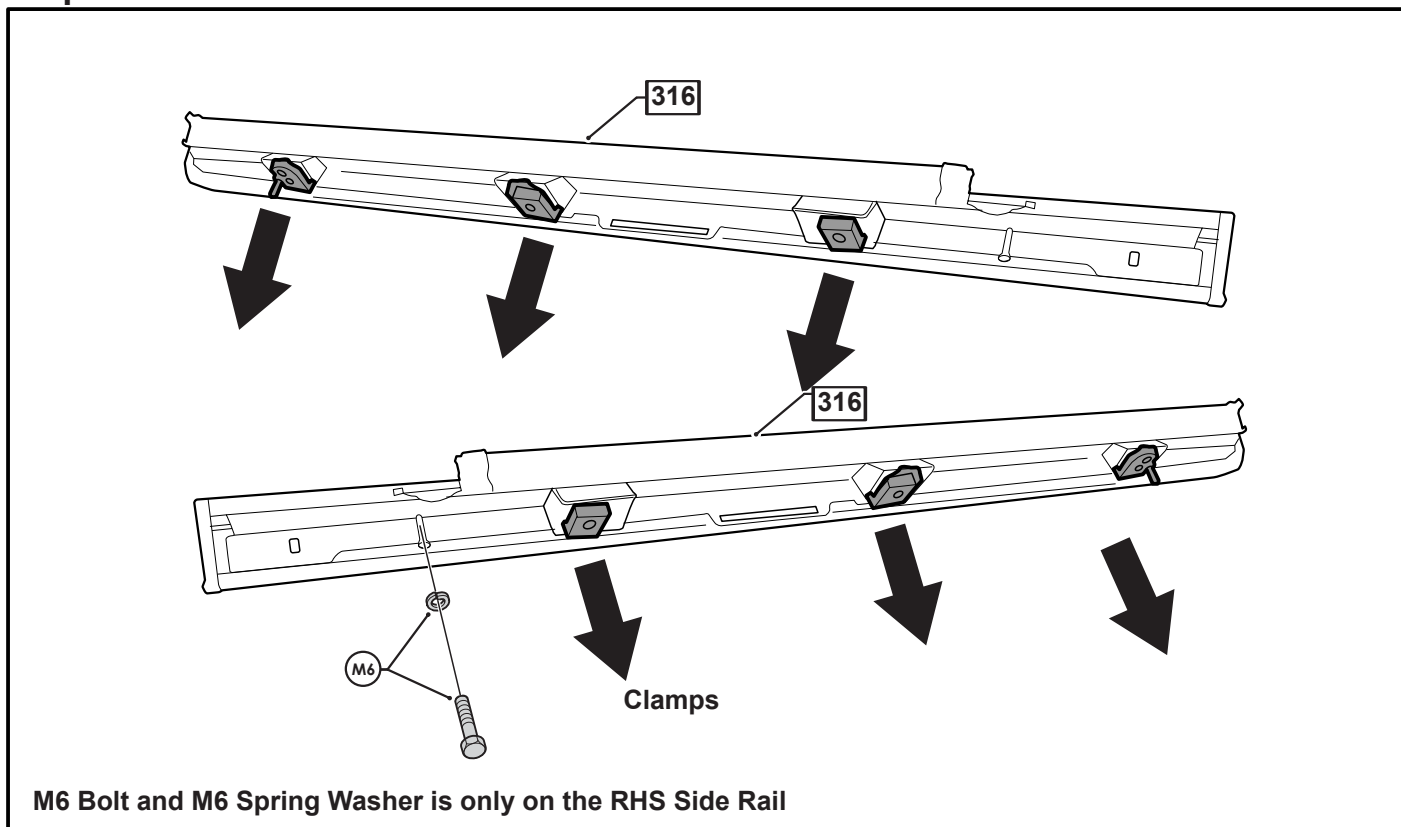

– Step 10

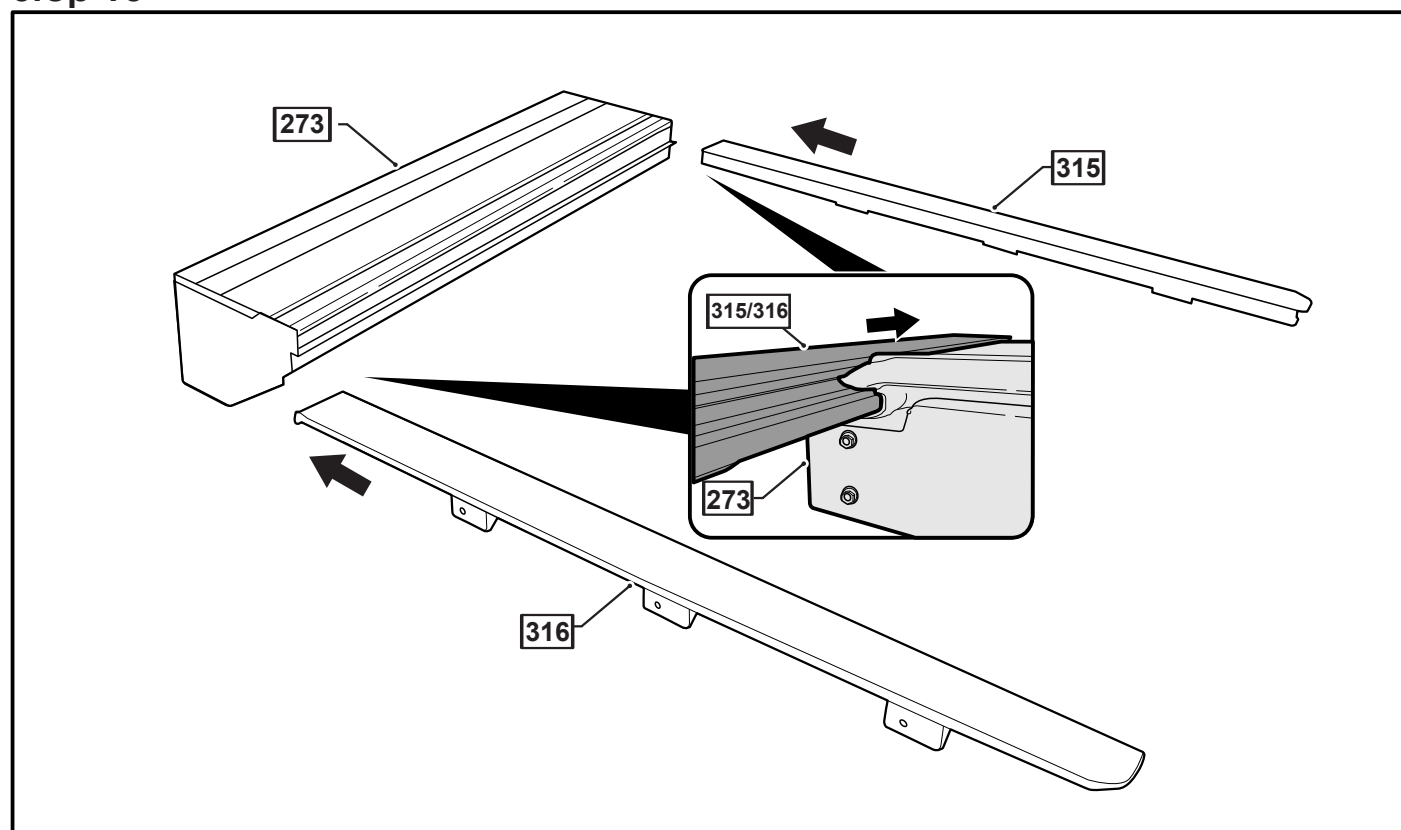

– Step 11

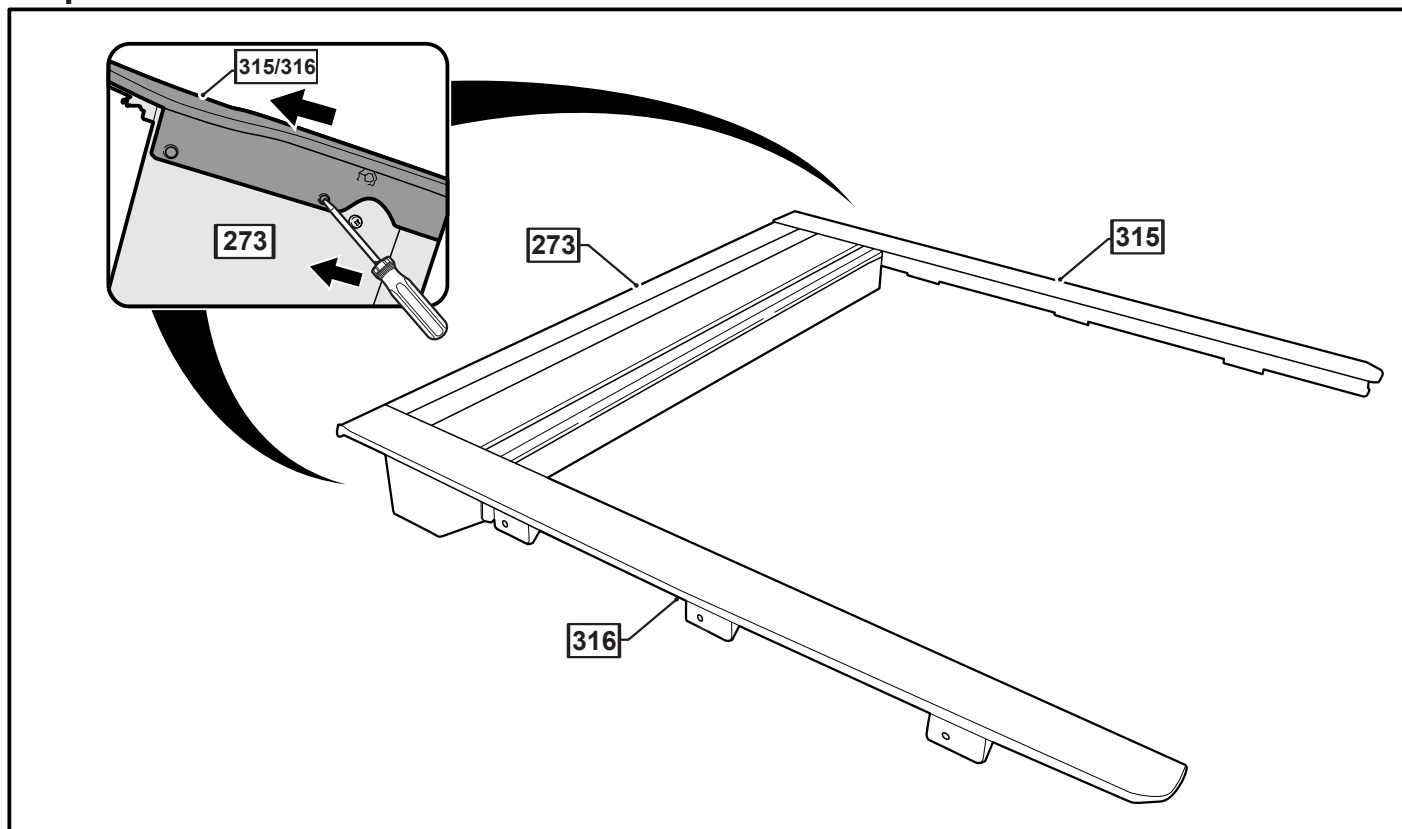

– Step 12

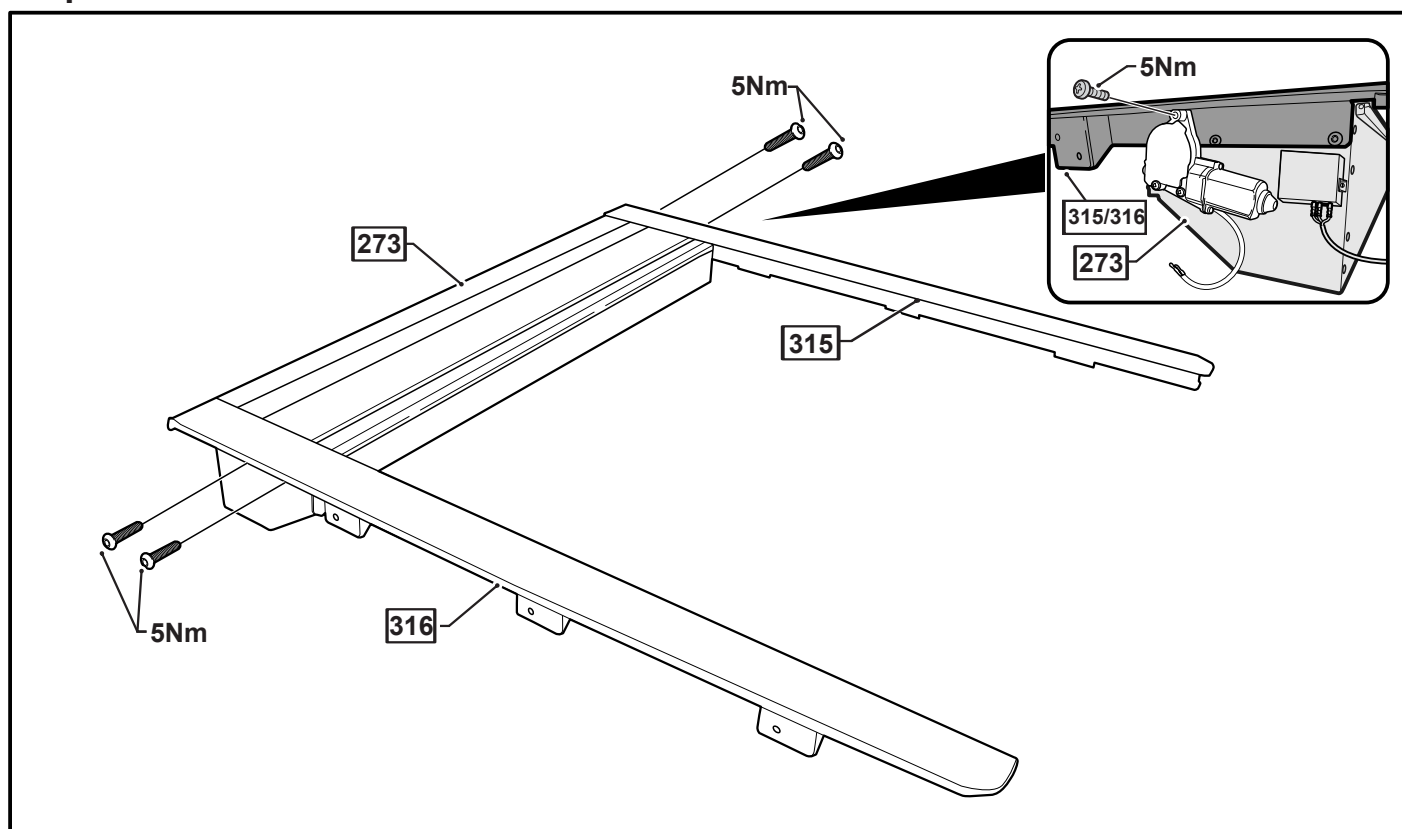

– Step 13 –

Apply tar sealant to the gap under water channel.

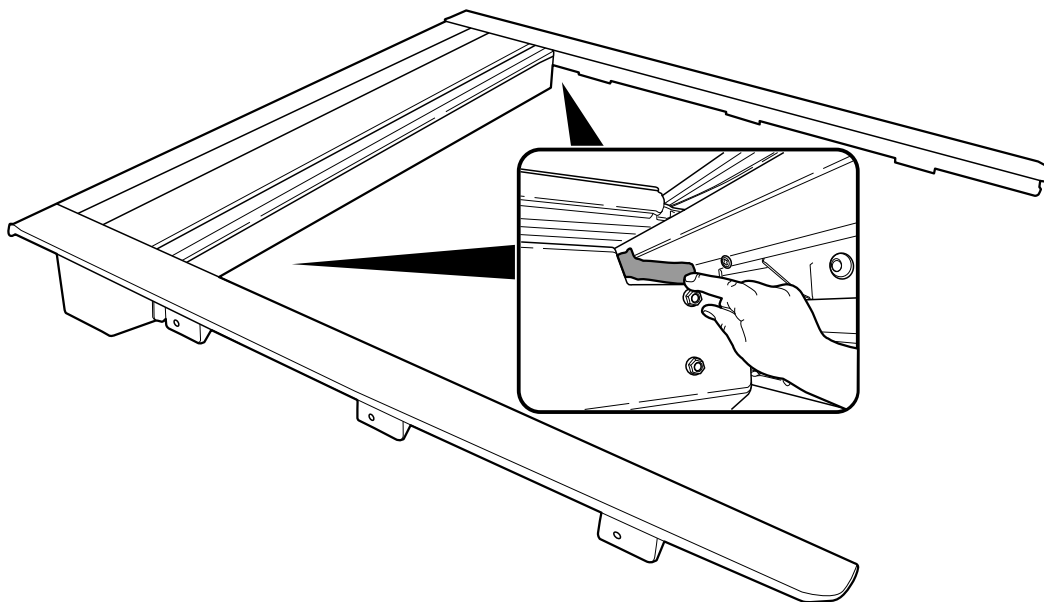

– Step 14 –

Apply tar sealant to both sides of the canister as shown (where accessible).

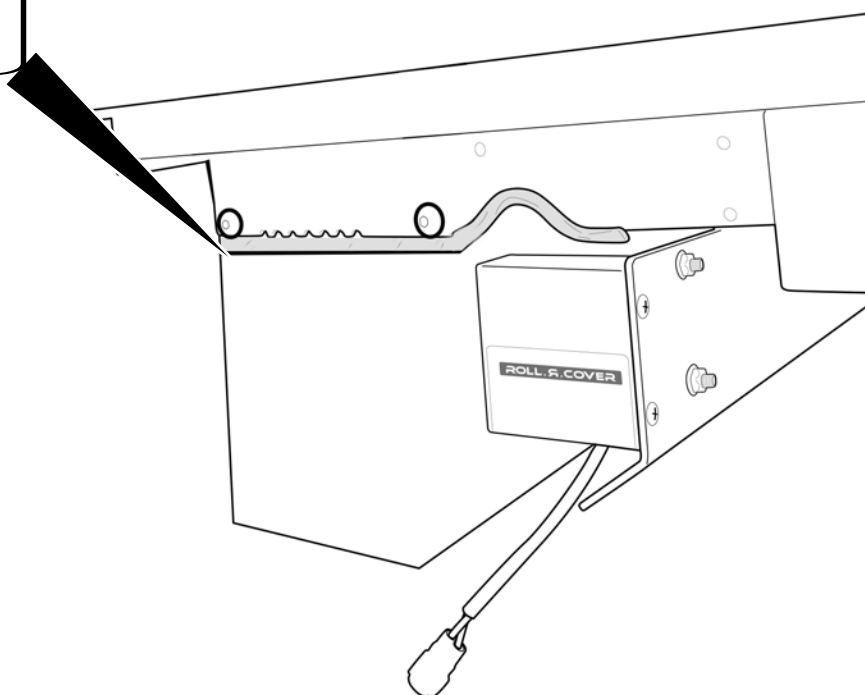

– Step 15 –

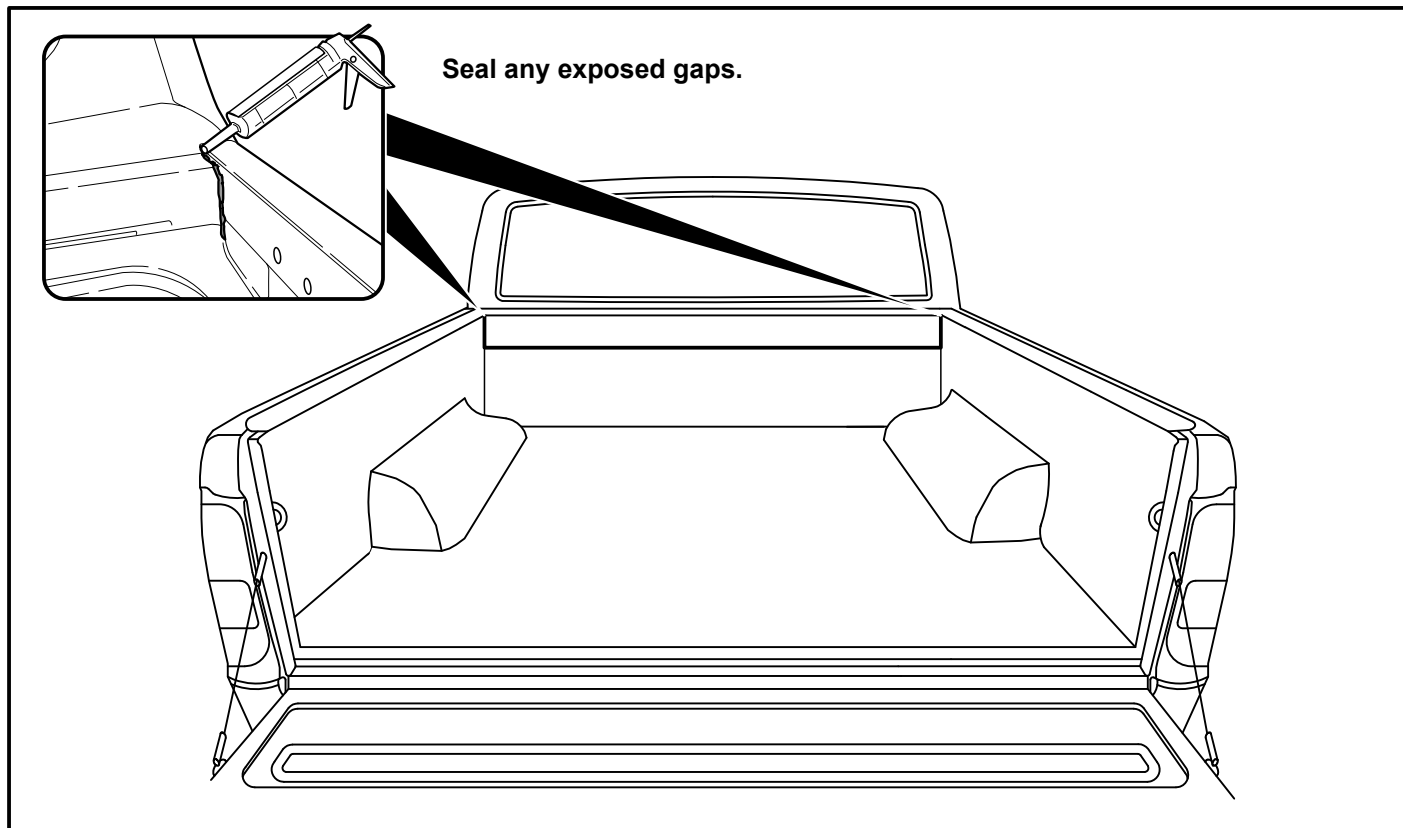

– Step 16 –

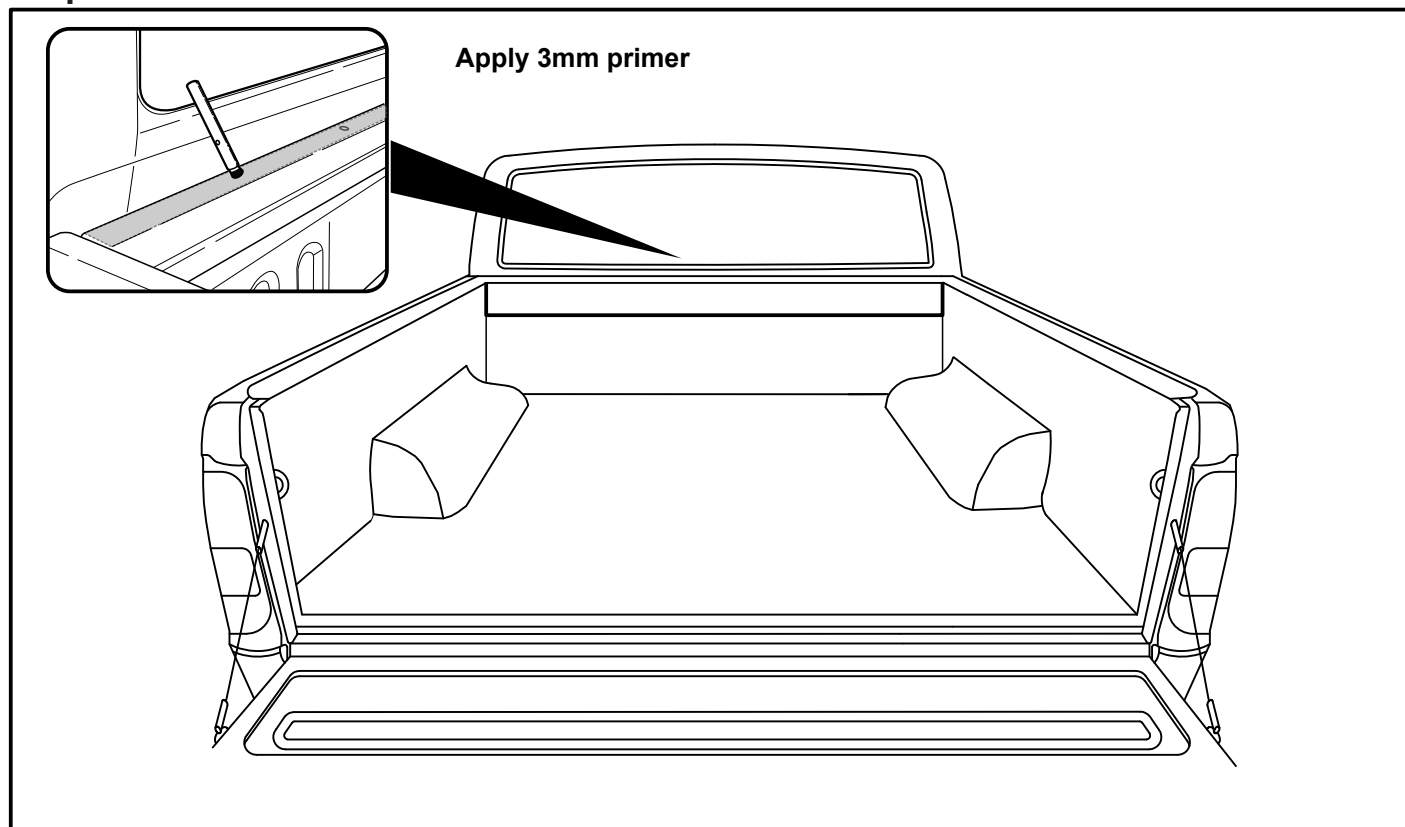

– Step 17 –

Installing the Roll-R-Cover

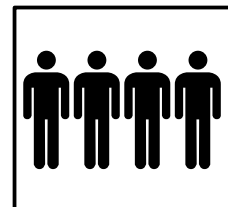
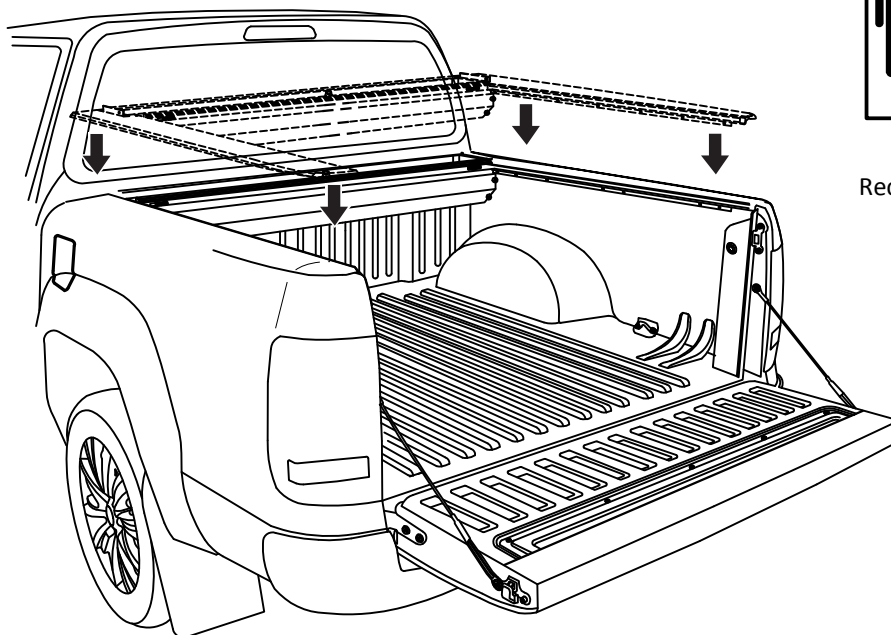

4 People
Recommended for lift

– Step 18 –

Before dropping the Roll R cover into place on the tub, connect all relevant connections or plugs to the receiver and motor plug connection.

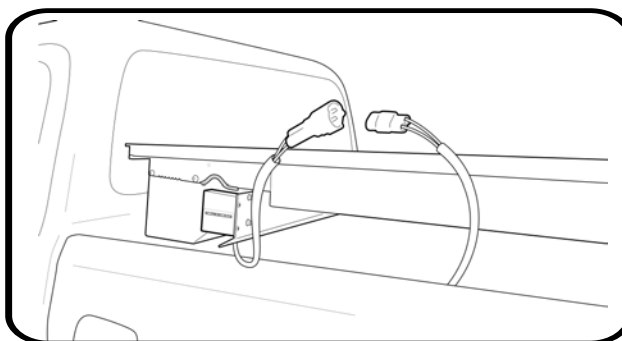
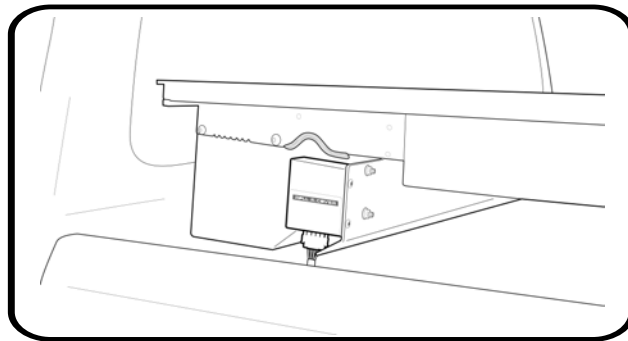
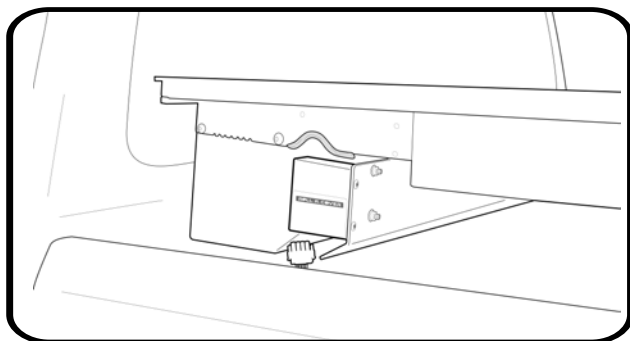

– Step 19

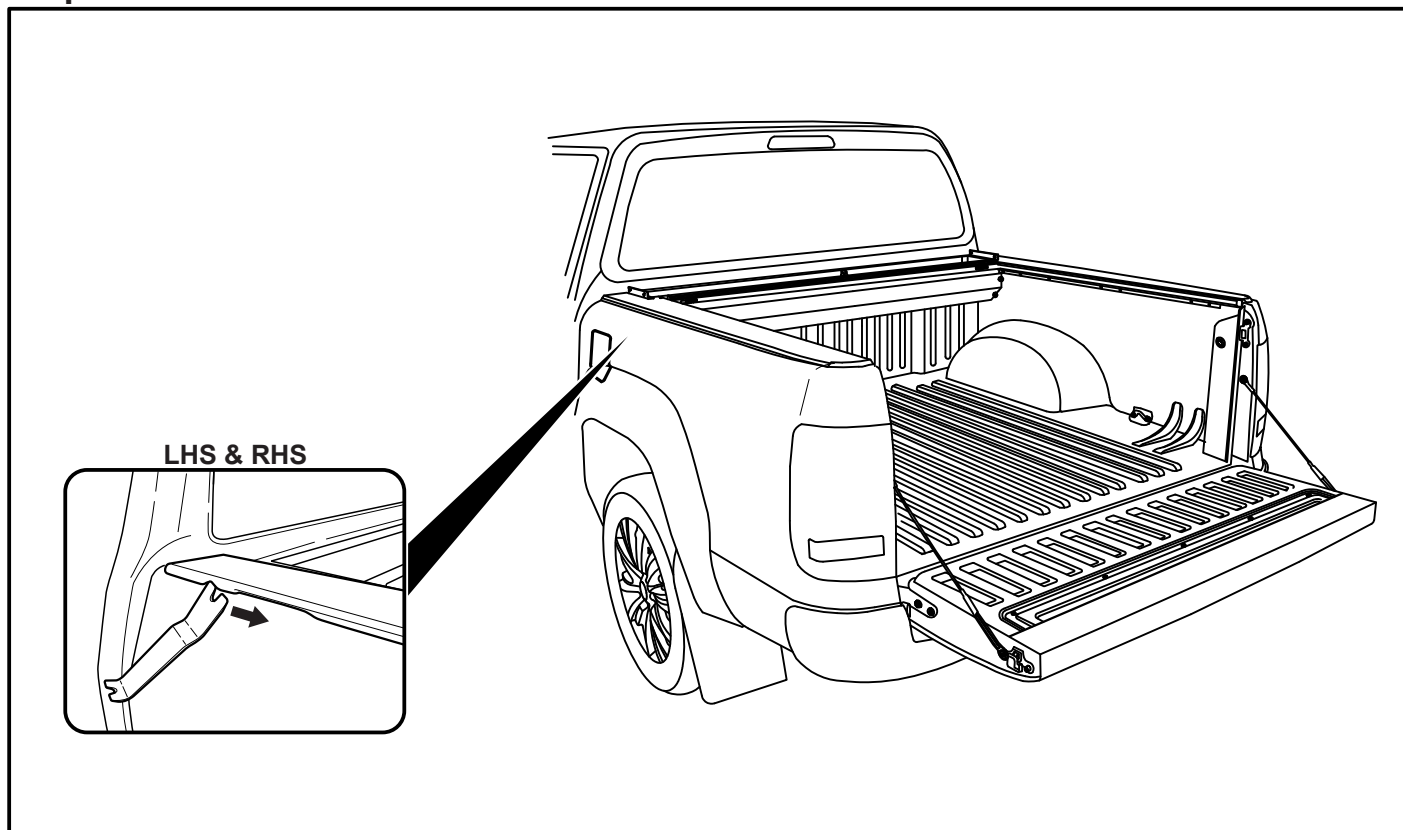

– Step 20

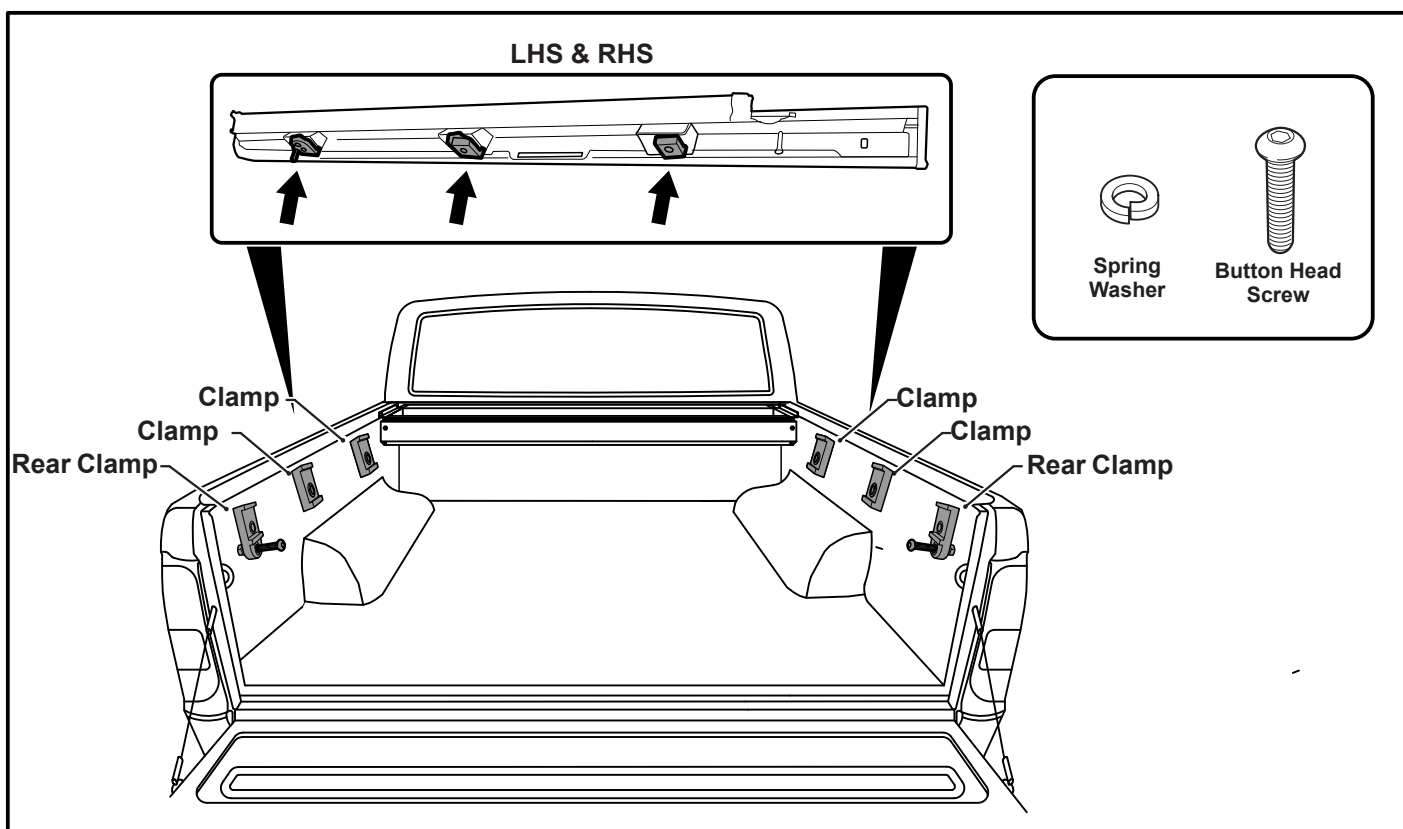

– Step 21 –

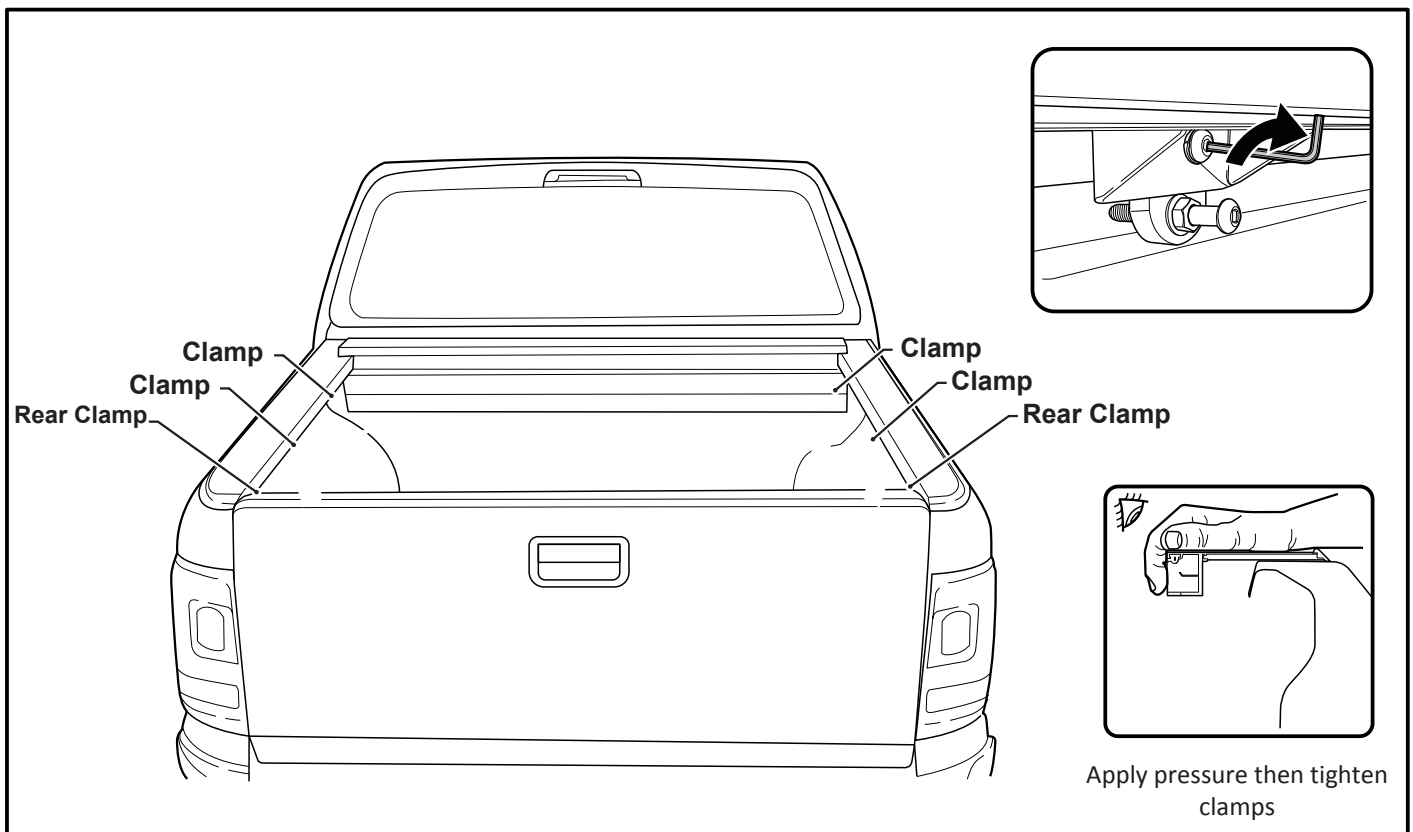

– Step 22 –

If curtain doesn't meet the tailgate in it's fully closed position, loosen the clamps and shift the unit back.

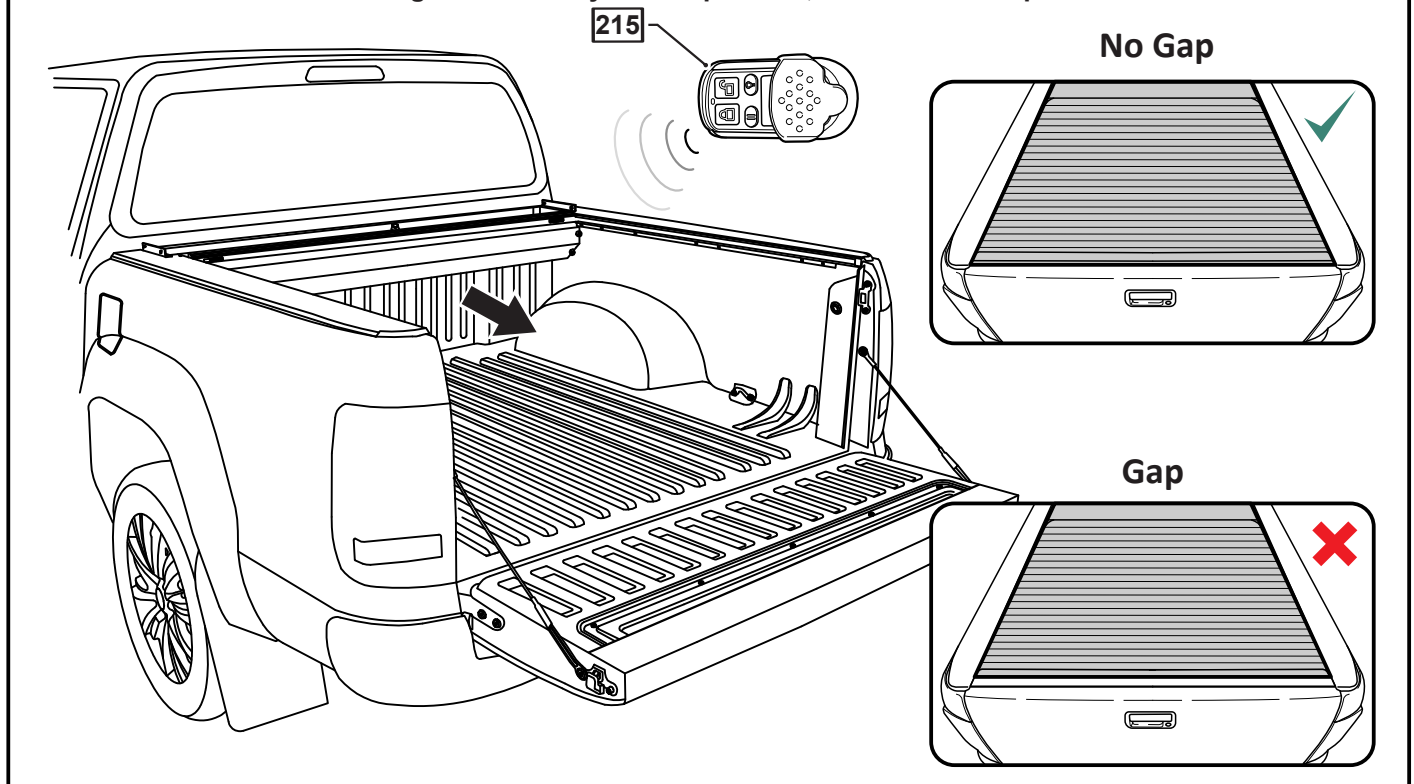

– Step 23

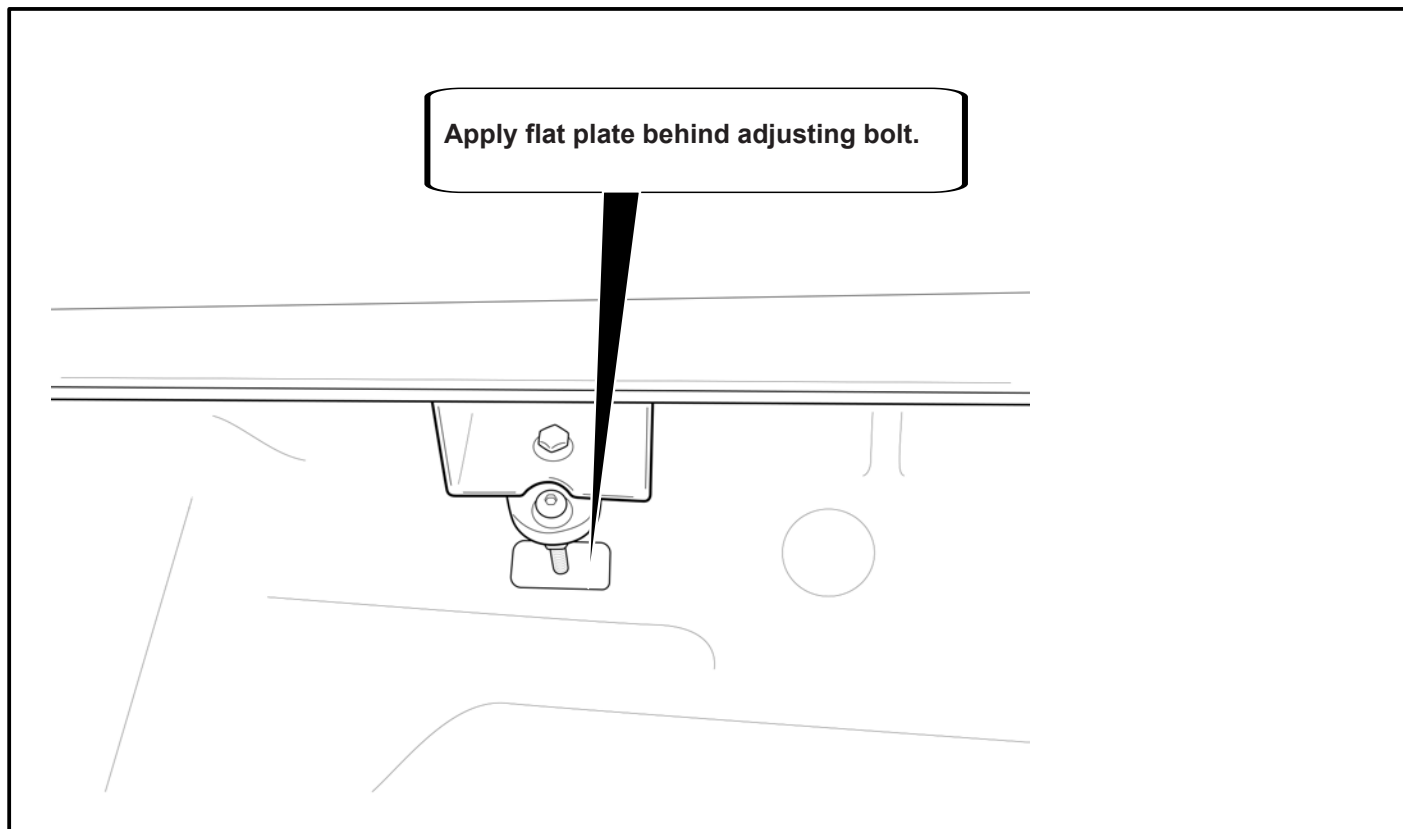

– Step 24

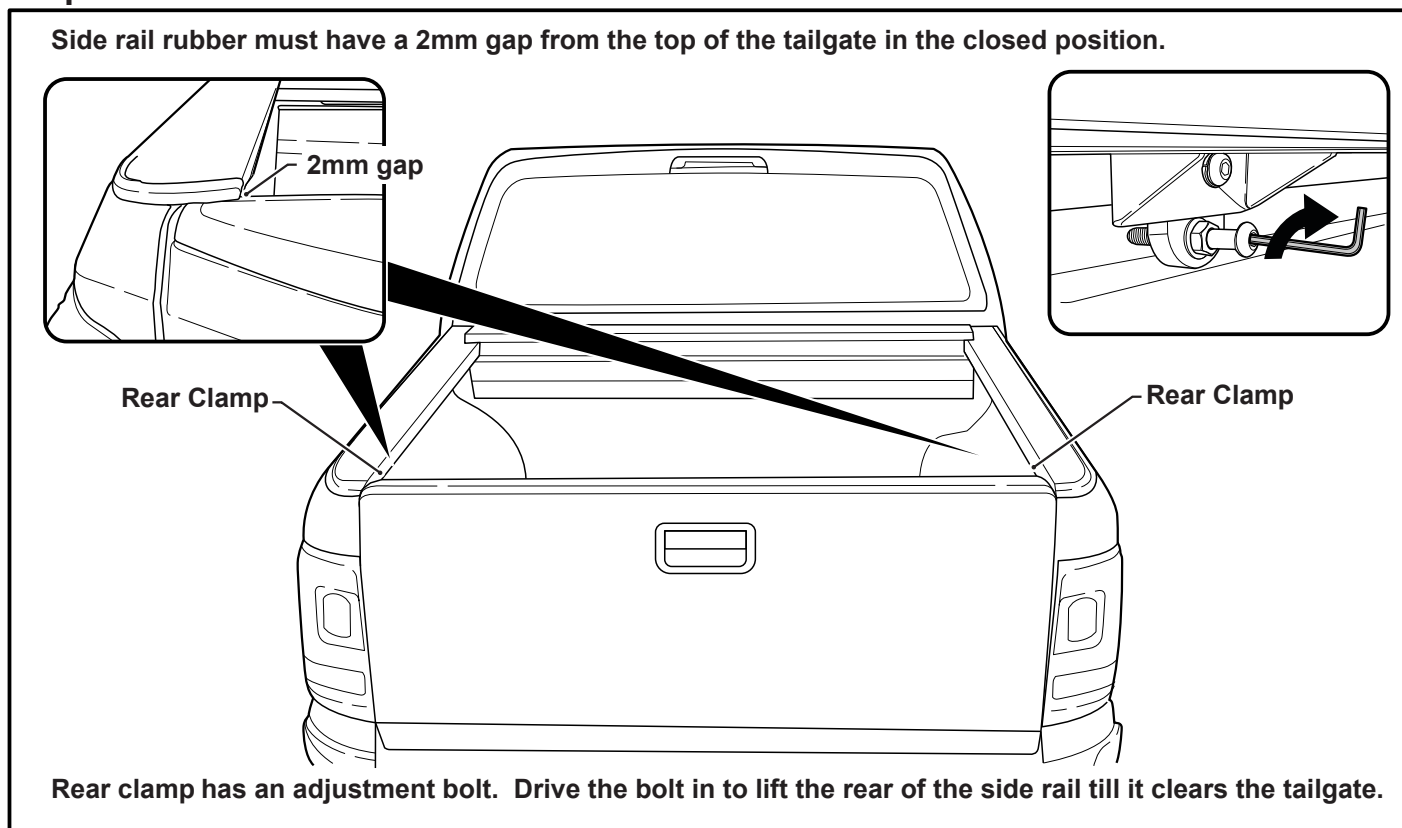

– Step 25

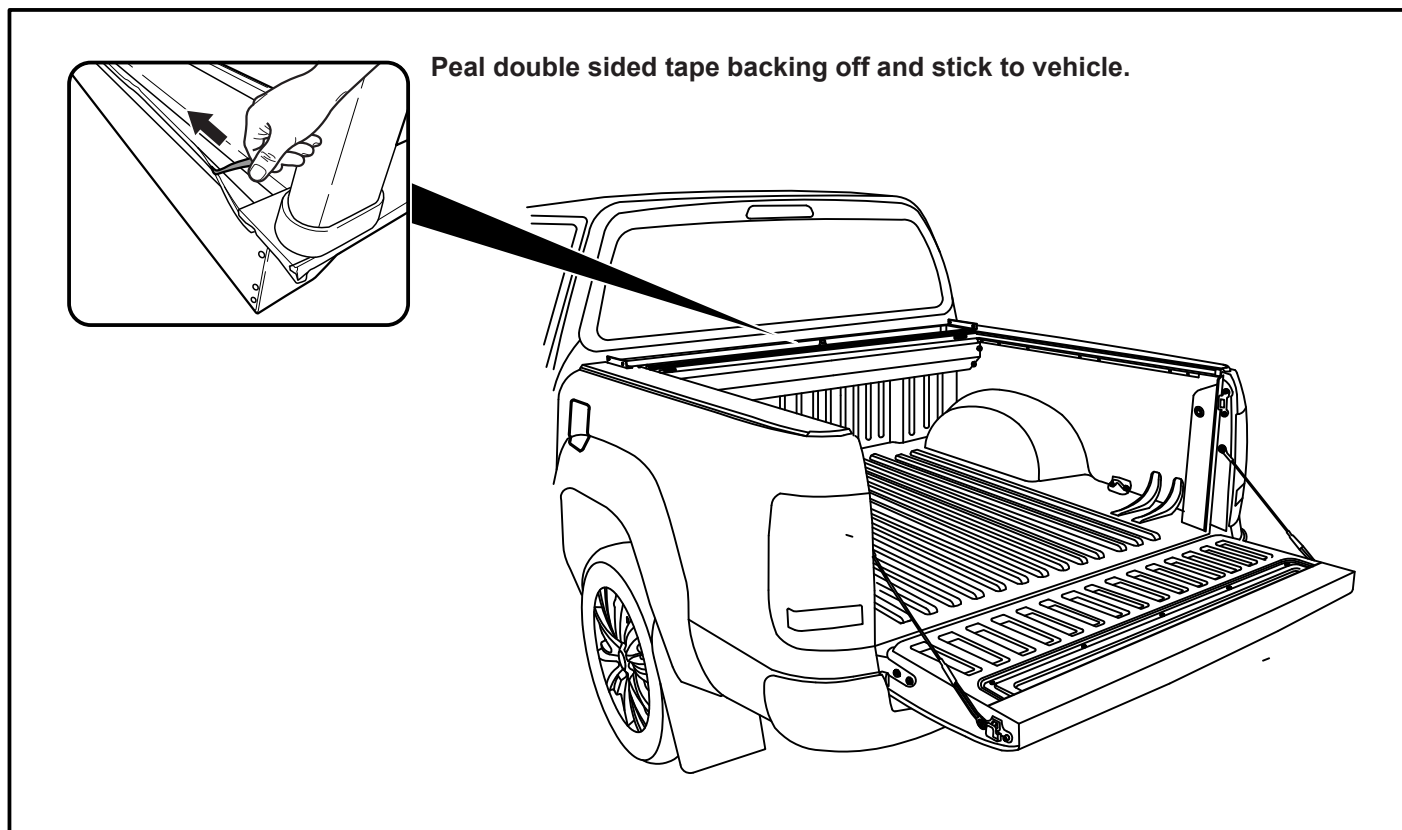

– Step 26

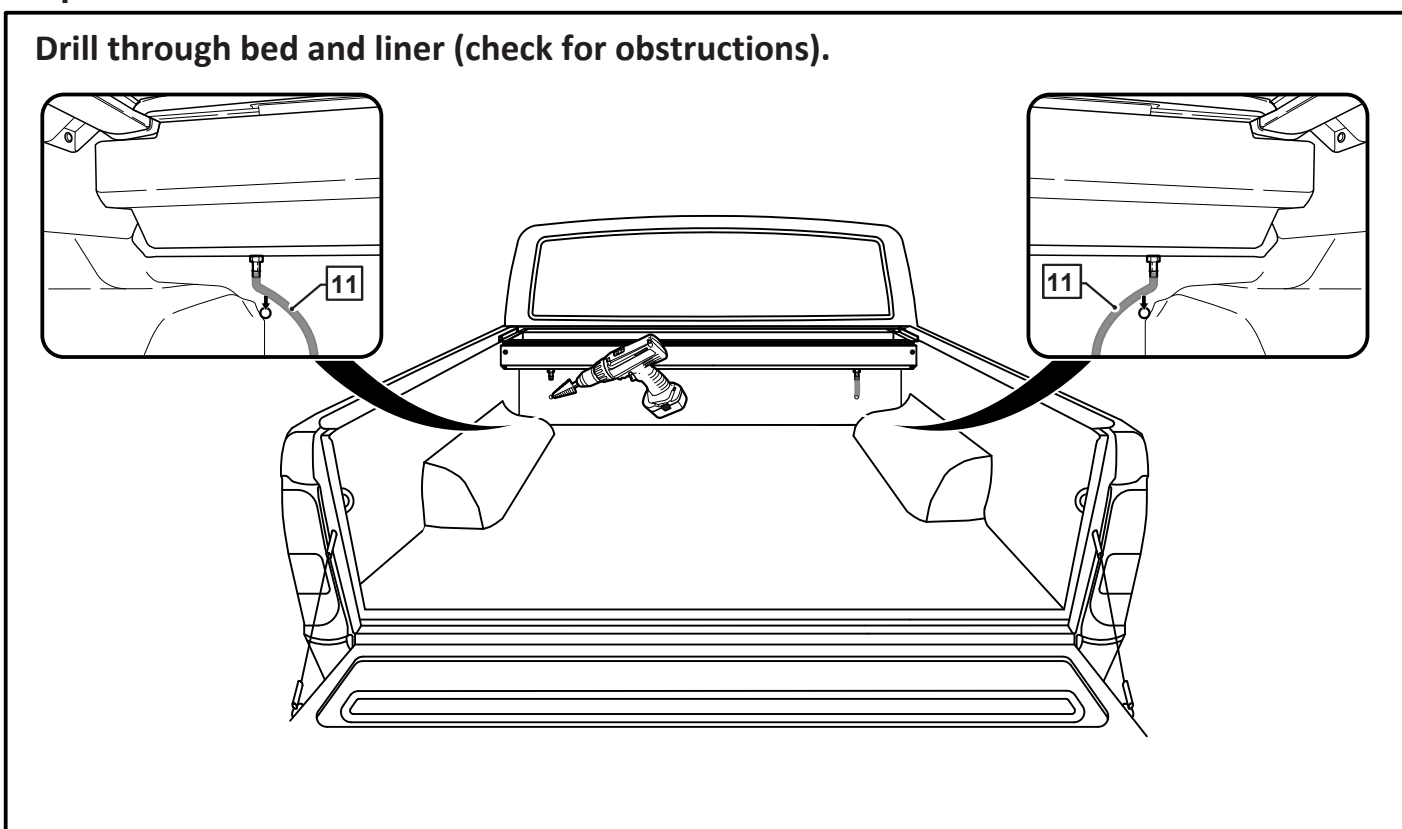

– Step 27 –

Remove the tail light to check for obstructions before drilling

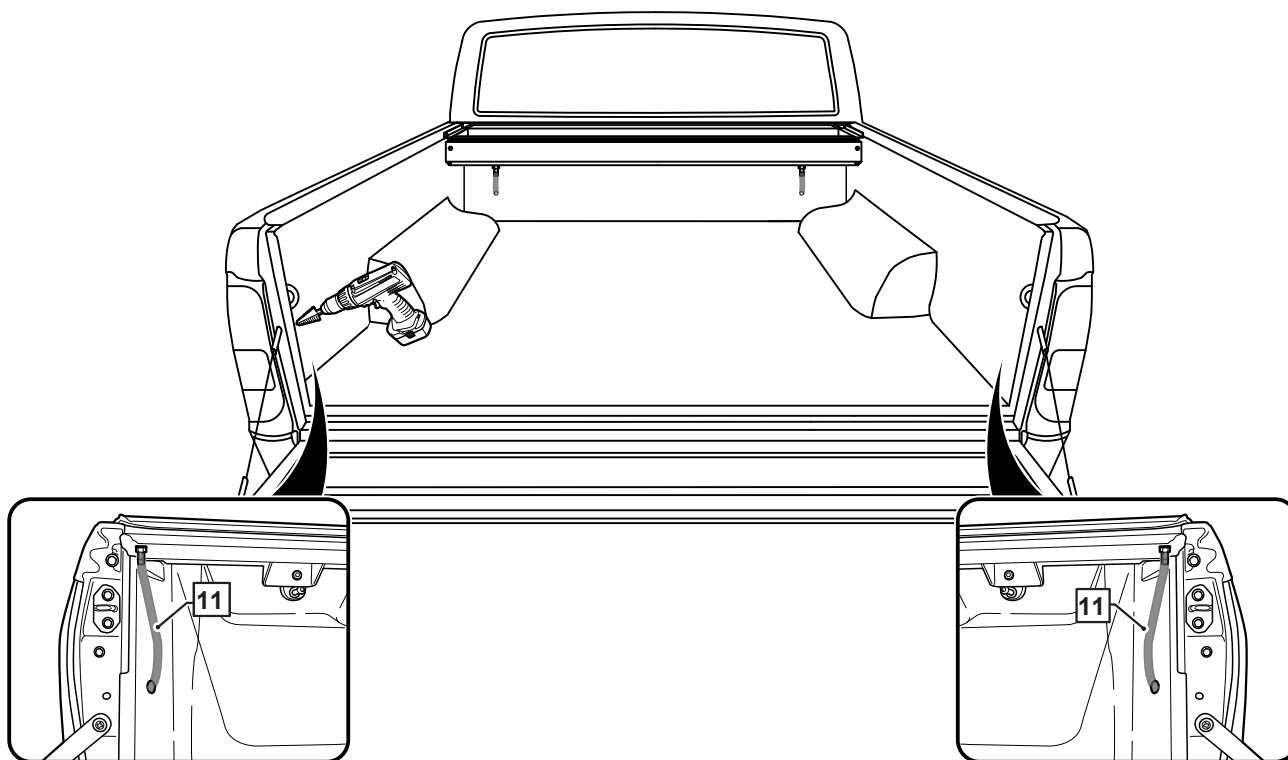

– Step 28 –

Snap fit the top cover.

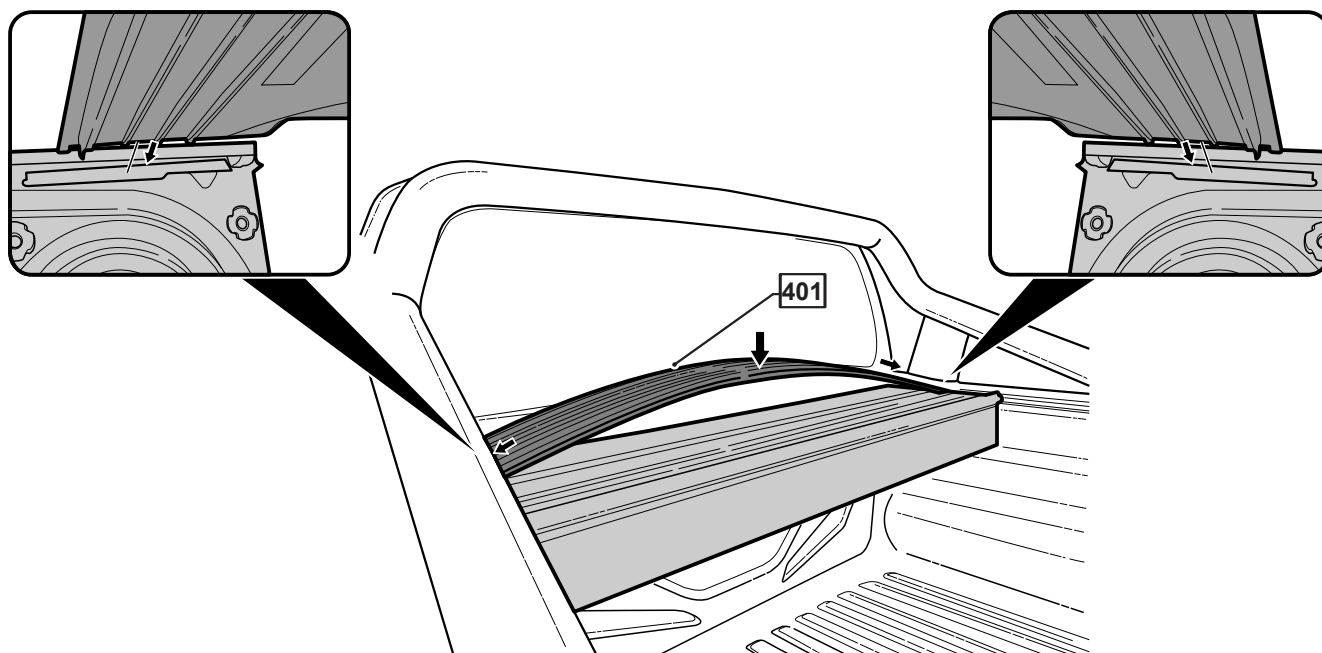

– Step 29 –

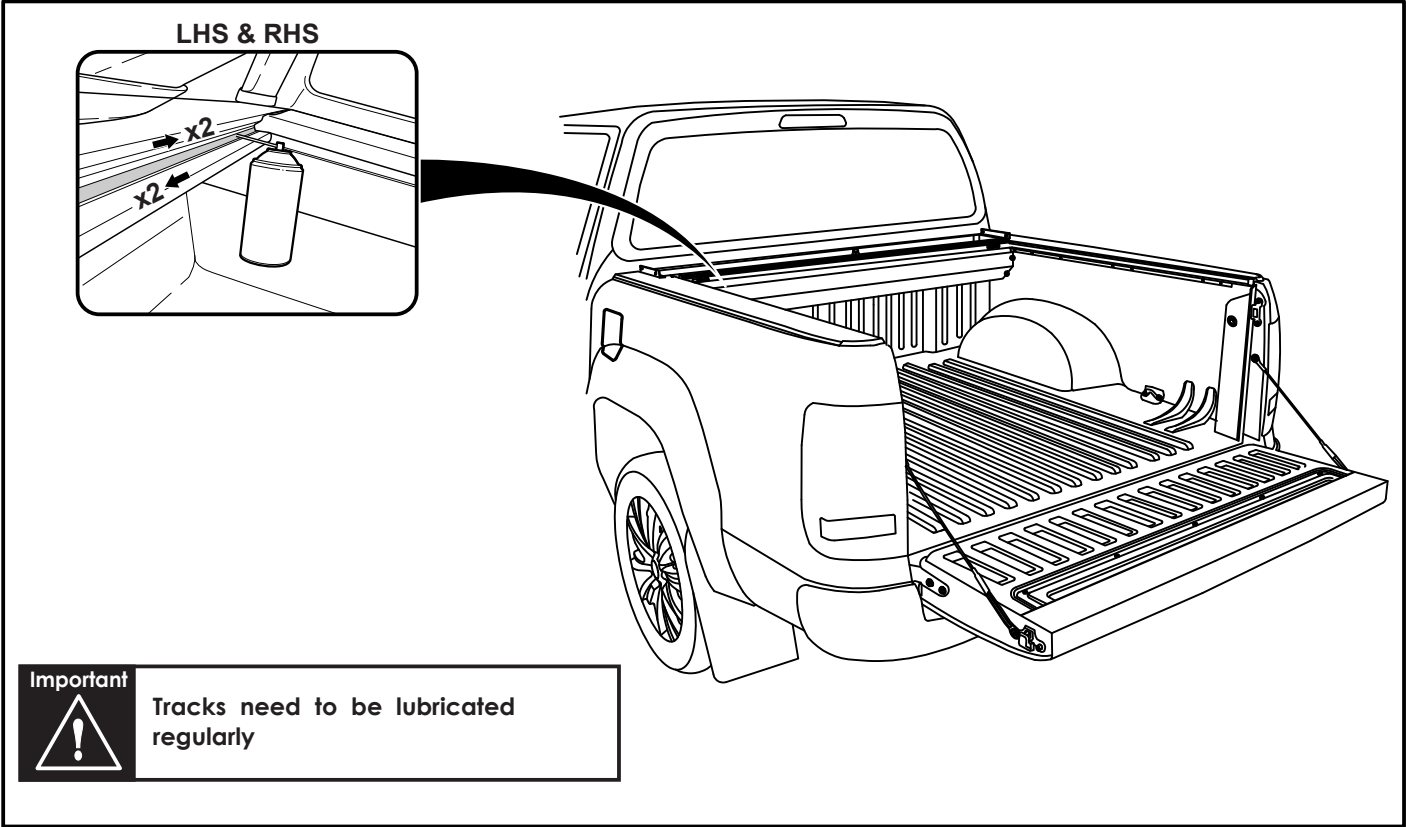

– Step 30 –

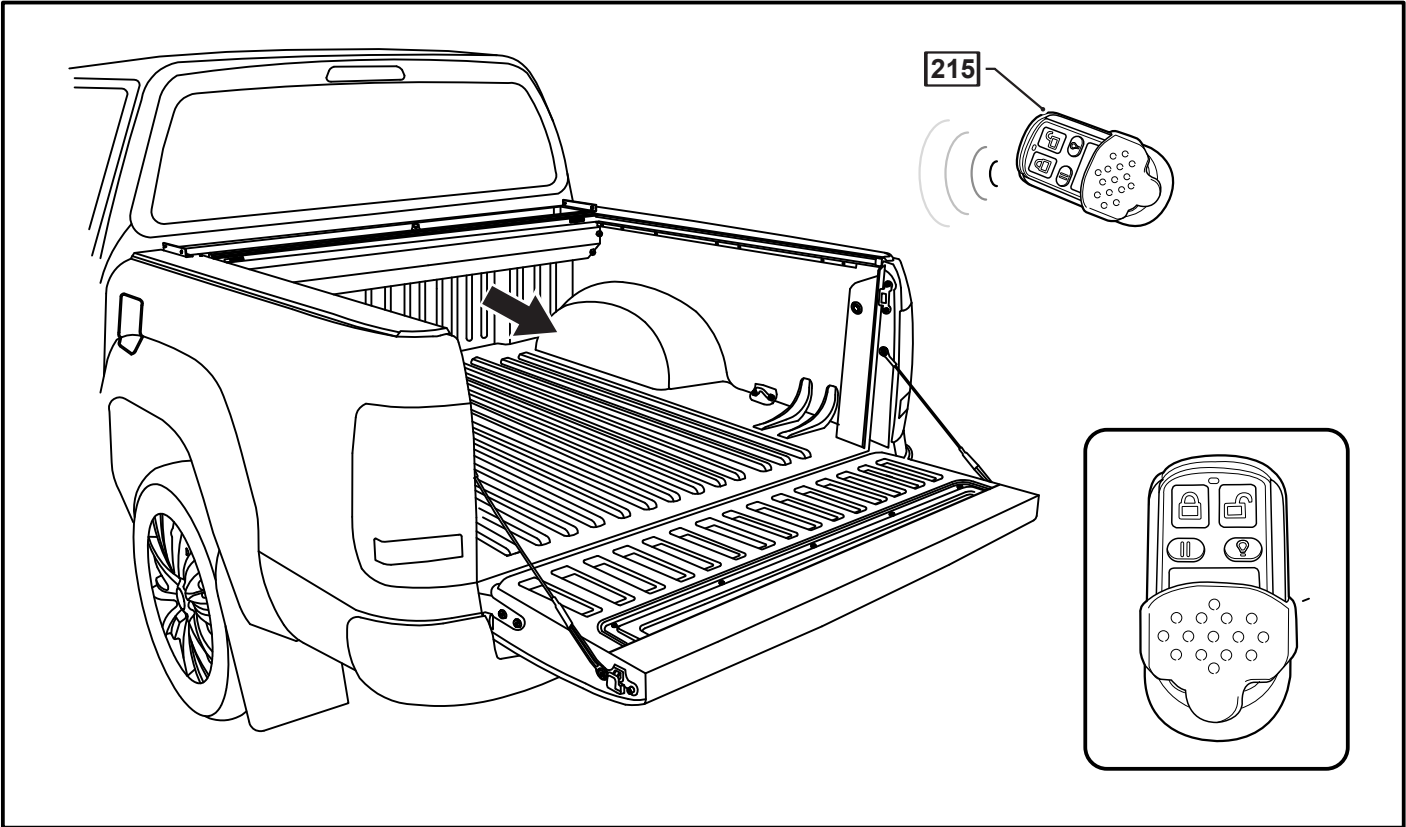

Important



You may open tailgate when Roll R Cover is in closed position, however you **MUST NOT** close the tailgate when Roll R Cover curtain is in the fully closed position.

WARNINGS!

www.hsputelids.com

 <div>NO STANDING</div>	<div>ENSURE  LOAD IS SECURE</div>	 <div>CHECK GLIDES OIL REGULARLY</div>	 <div>6Nm CHECK CLAMPS AND TIGHTEN</div>	 <div>DO NOT PLACE LOAD ON COVER</div>	<div>CHECK DRAIN  CLEAN CANISTER</div>	 <div>MECHANICAL HAZARD</div>	<div>NO PEOPLE OR  ANIMALS UNDER ROLL TOP</div>
--	--	---	---	---	---	--	--