



www.hsputelids.com  
1300 441 498  
Part number: GWM18



GWM UTE 2020+

HSP TAIL LOCK

---

FITTING INSTRUCTIONS

## —General Notes

---

- Read through the fitting instructions prior to installation of accessory.
- Ensure all Recyclable components, packaging are discarded & recycled following local recycling regulations.
- Safely store and protect and removed vehicle components.

## —Safety Notes

---

- Check that all work practices comply with safety standards.
- Please wear appropriate clothing and use safety equipment.
  
- WARNING Failure to install product not in accordance with manufacturers instructions may result in fire.
  
- WARNING Failure to install product not in accordance with manufacturers instructions may void warranty.
- WARNING We recommend disconnecting the battery terminals before commencing install of tail lock. Please ensure you have your vehicle book with radio/infotainment codes on the unlikely chance these need to be re-entered in.

## —Fitting Time

---



45mins

## —PARTS SUPPLIED

---

Part Description	Part Number	Quality/ Length	CHECK LIST
<b>TAIL LOCK ASSEMBLY</b>			
Swing Bracket	GW18-1A	1	
Main Bracket	GW18-1B	1	
Actuator	ACT-01	1	
Wiring	CL-LOOM-LONG	1	
Patch Wiring	GWM-PATCH	1	
Lever	GW18-C	1	
Actuator Arm	ACT-01-C	1	
<b>FASTENERS</b>			
Actuator Screws	36	2	
M6Washer	46	1	
<b>OTHER</b>			
Foam seal	9MM x 6MM	180mm	
Cable Ties		5	
Fitting Instruction		1	

—STEP 1—

**NOTE:** This step is only for GWM with a built-in step in the tail gate.

1. Release and drop step down.

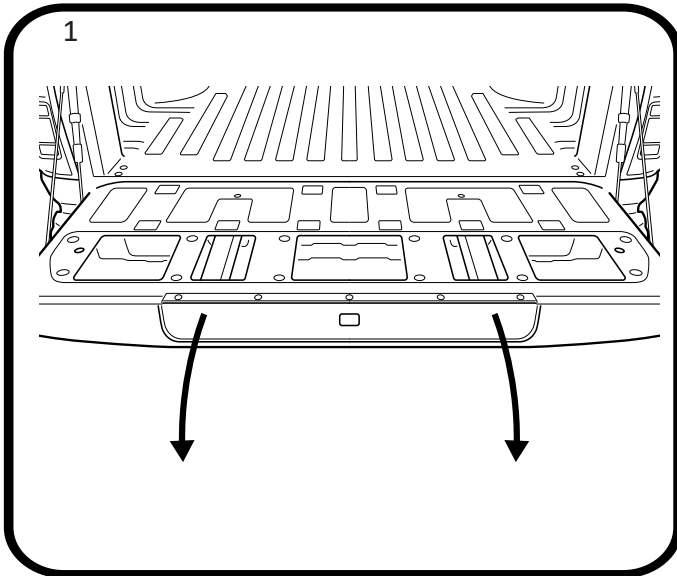

2. Remove and retain clips and plastic shroud

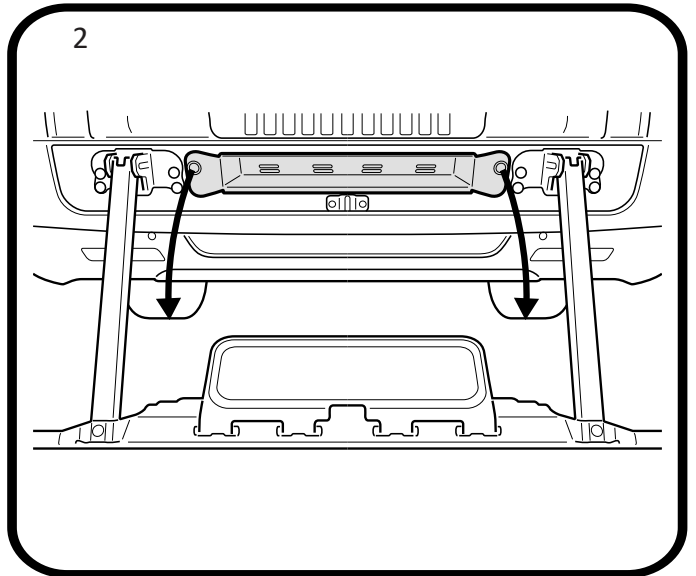

3. Seal the two center holes with foam seal provided

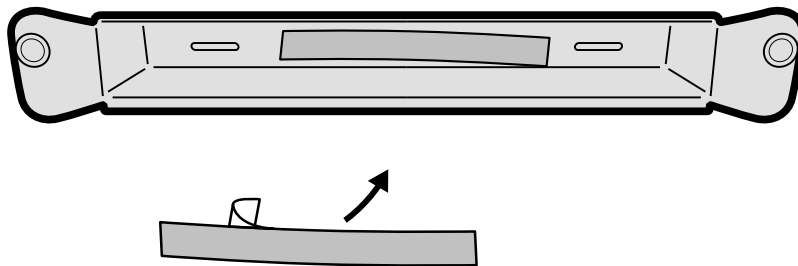

—STEP 2—

Remove tail gate cover.

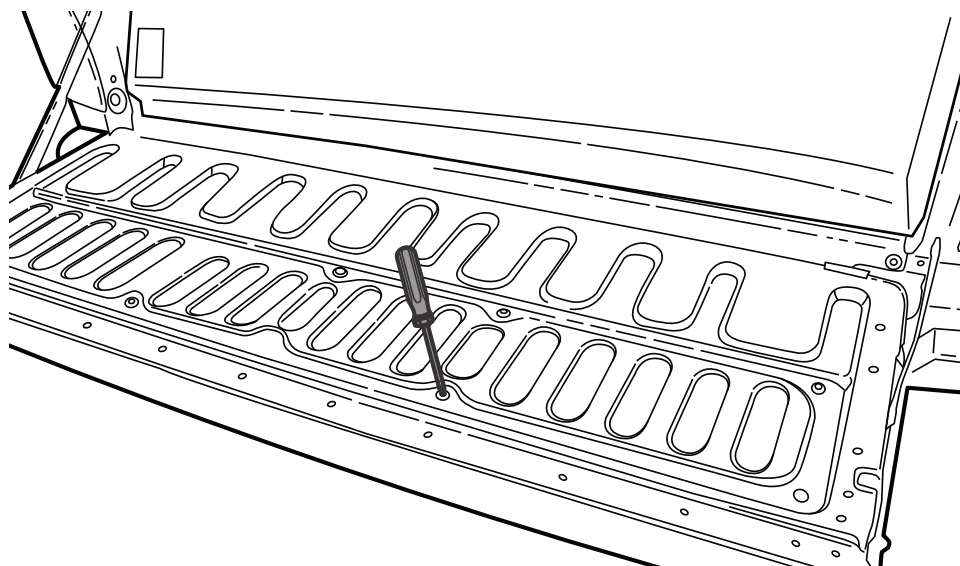

— STEP 3 —

1. Disconnect the indicated rods.

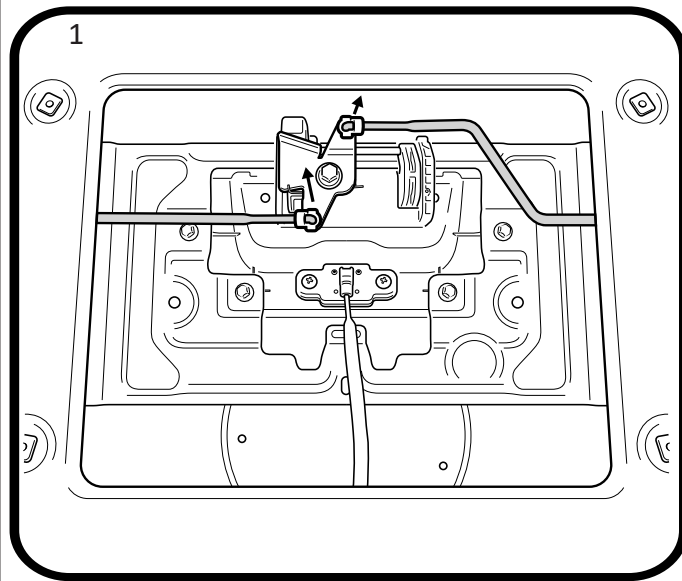

2. Unfasten the indicated bolt & retain.

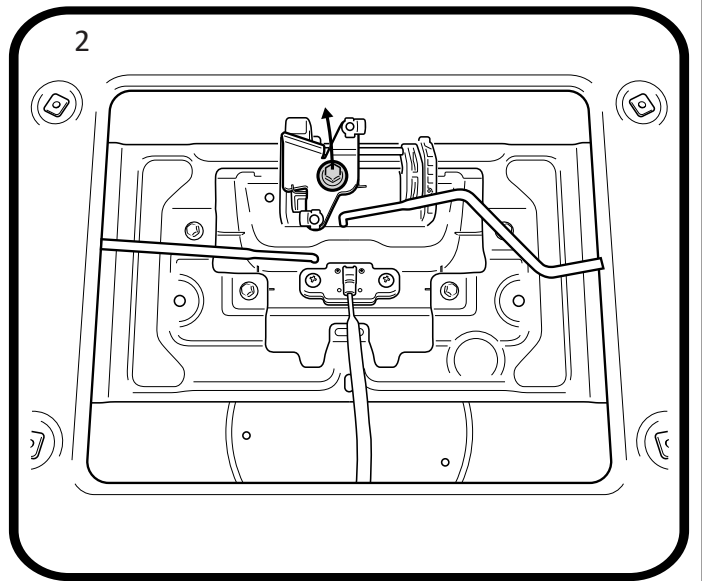

— STEP 4 —

1. Disconnect the indicated rods.

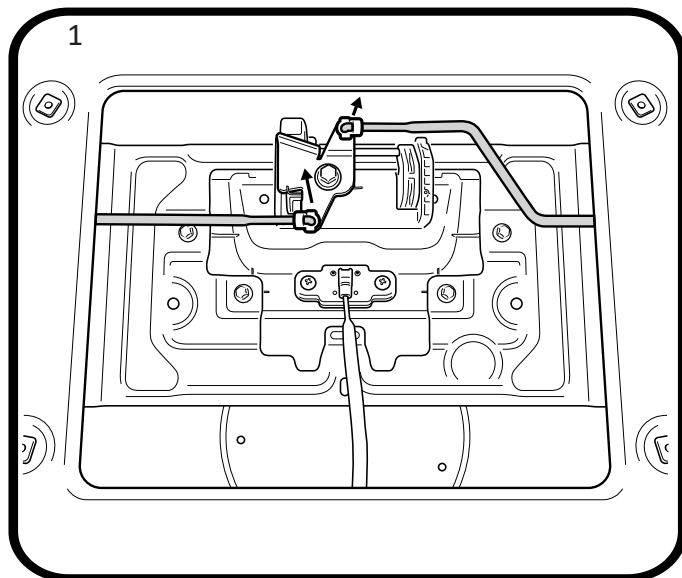

2. Unfasten the indicated bolt, spring washer & retain. Discard the raised washer.

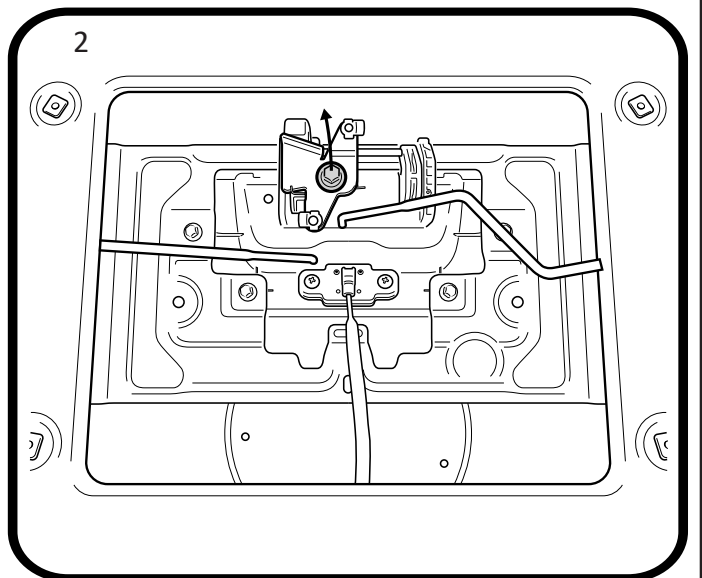

— STEP 5 —

Remove factory bracket.

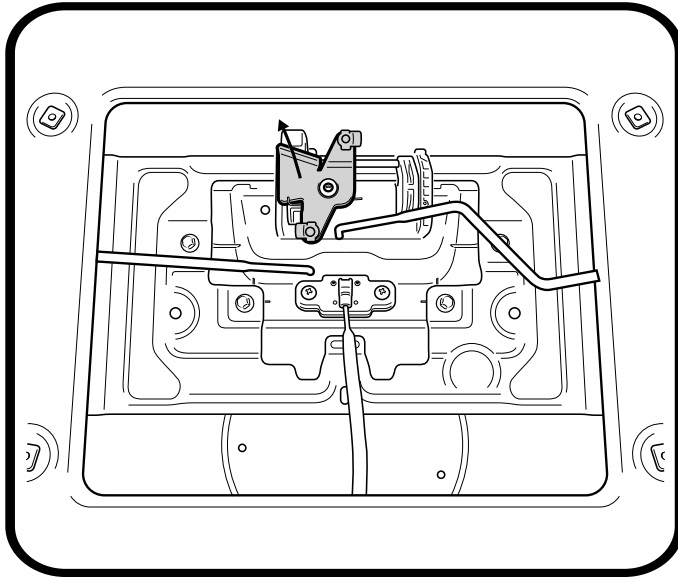

Retain the factory spring in position.

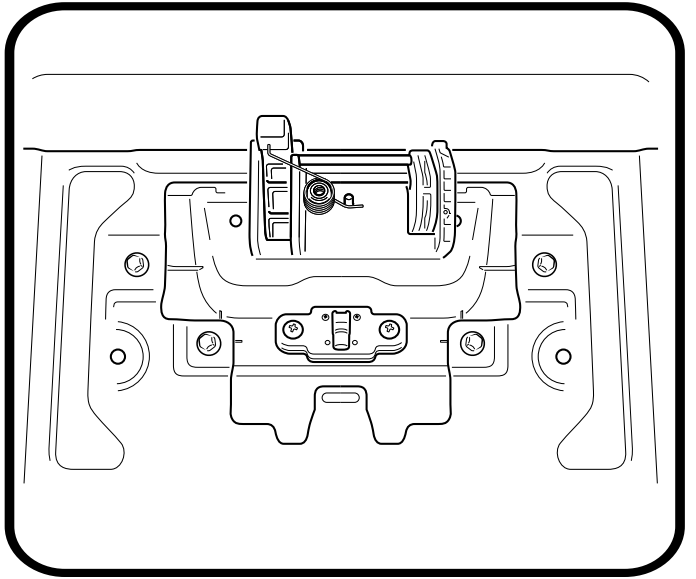

— STEP 6 —

Push through the rod clips from the factory bracket & retain.

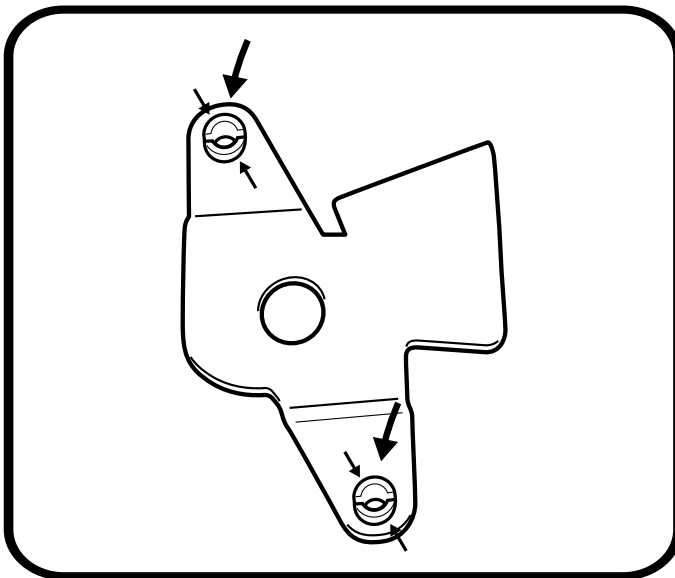

Fit the factory rod clip into part number GW18-1B

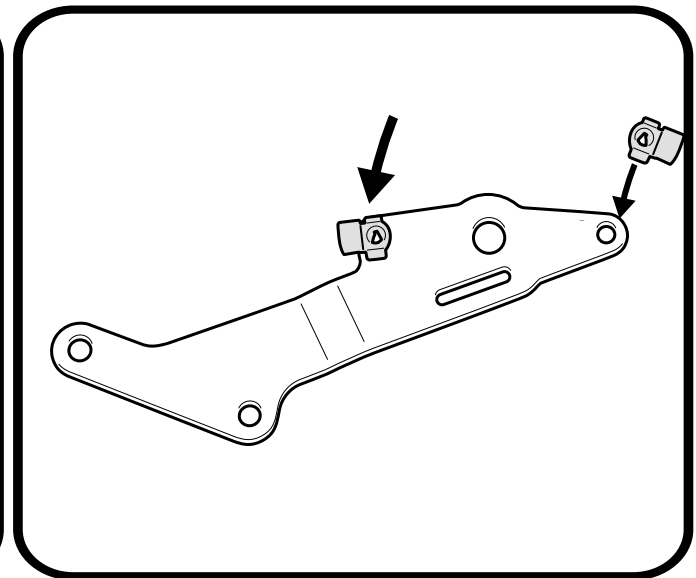

—STEP 7—

Load lever ( GW18-C ) on to ACT-01-C (actuator arm)

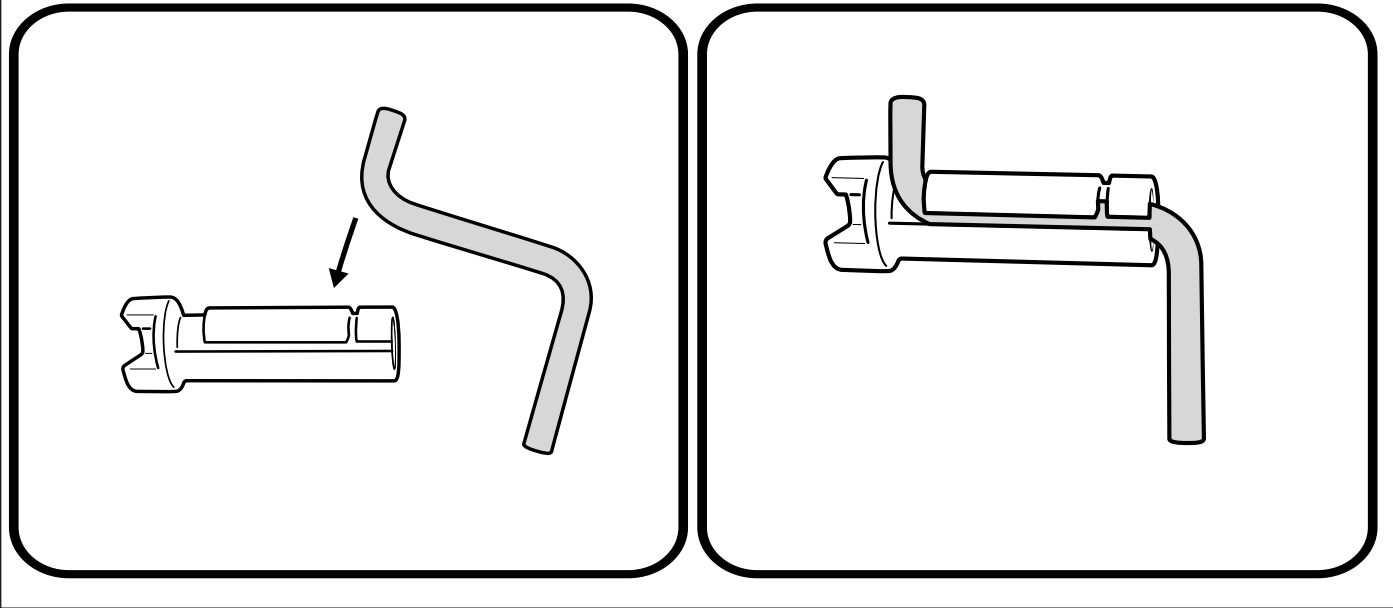

—STEP 8—

Push plastic striker (ACT-01-C) on to the actuator (ACT-01) until it clicks into position on to ACT-01.  
Feed lever through GW18-1B.

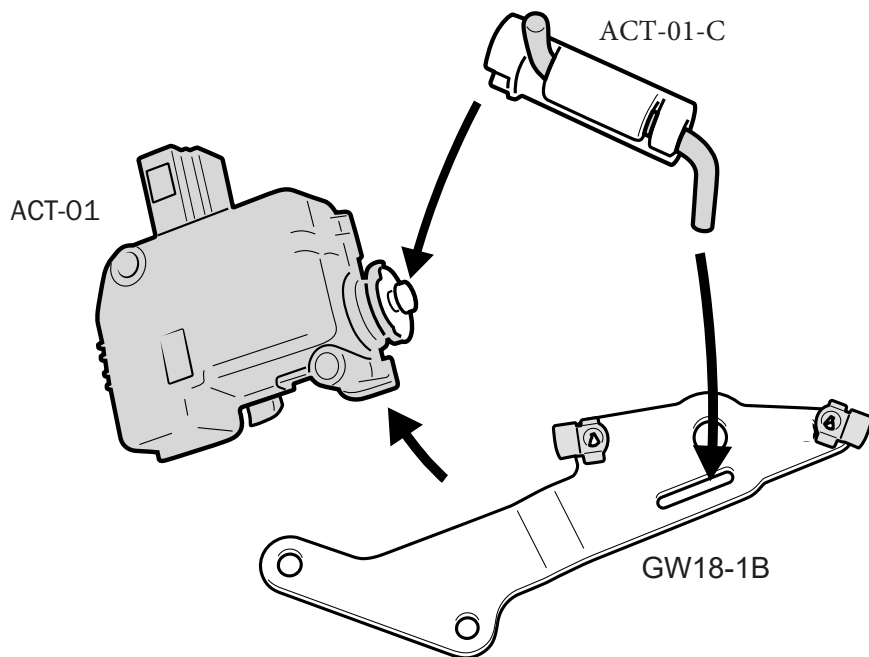

—STEP 9—

Assembled view.

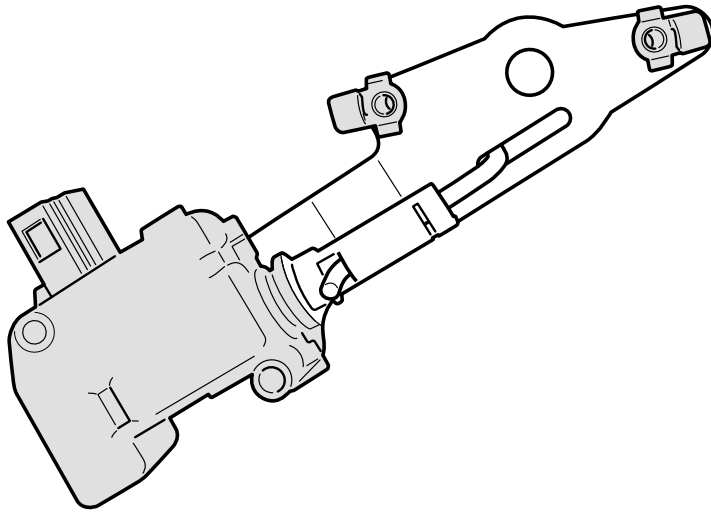

—STEP 10—

Fasten the actuator using part number 36 ( screws)

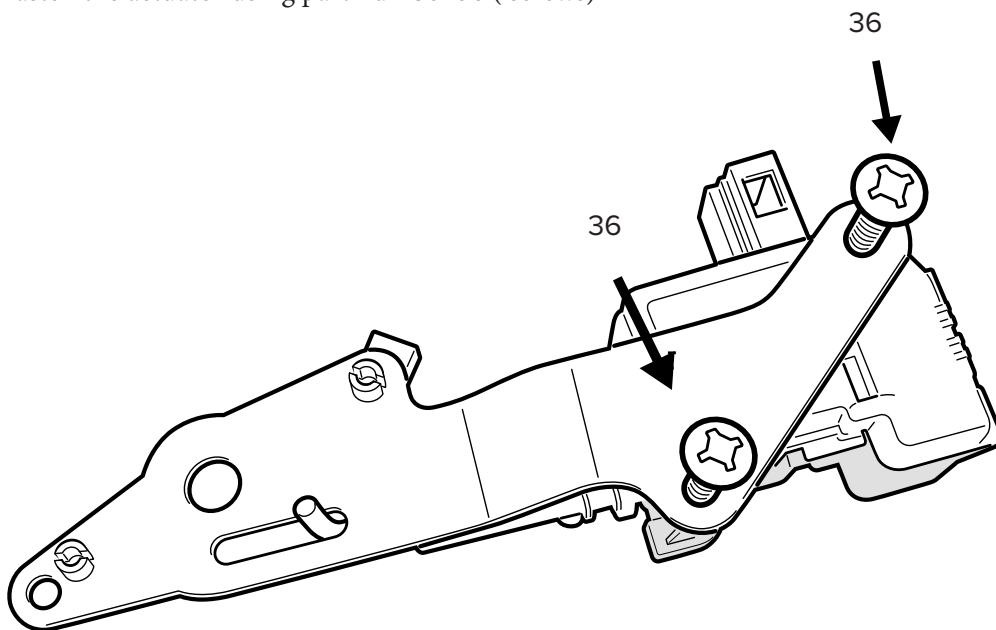

— STEP 11 —

Place bracket GW18-1A as indicated.

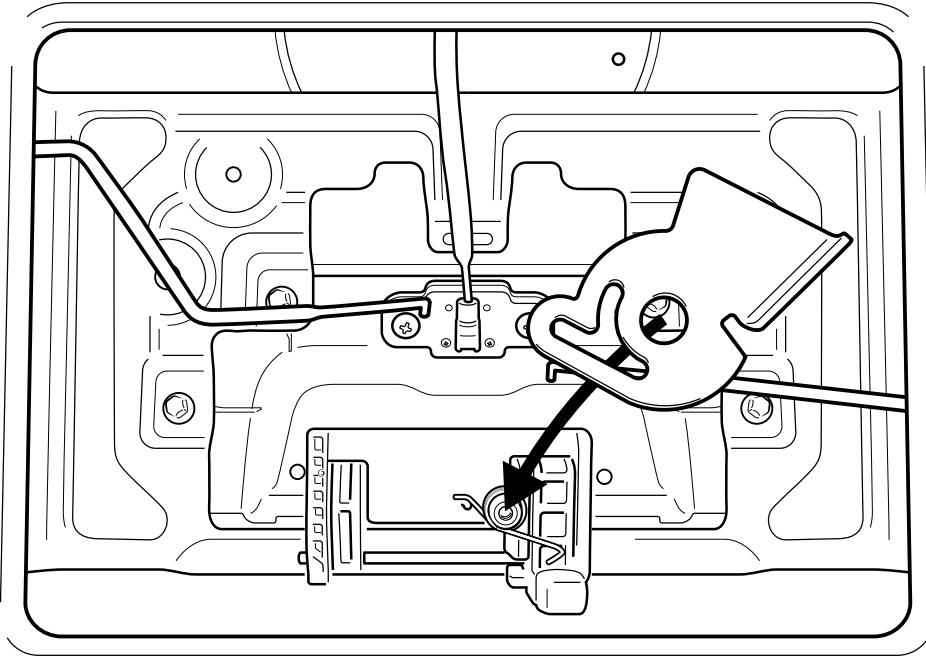

— STEP 12 —

Hook the spring over the bracket as indicated.

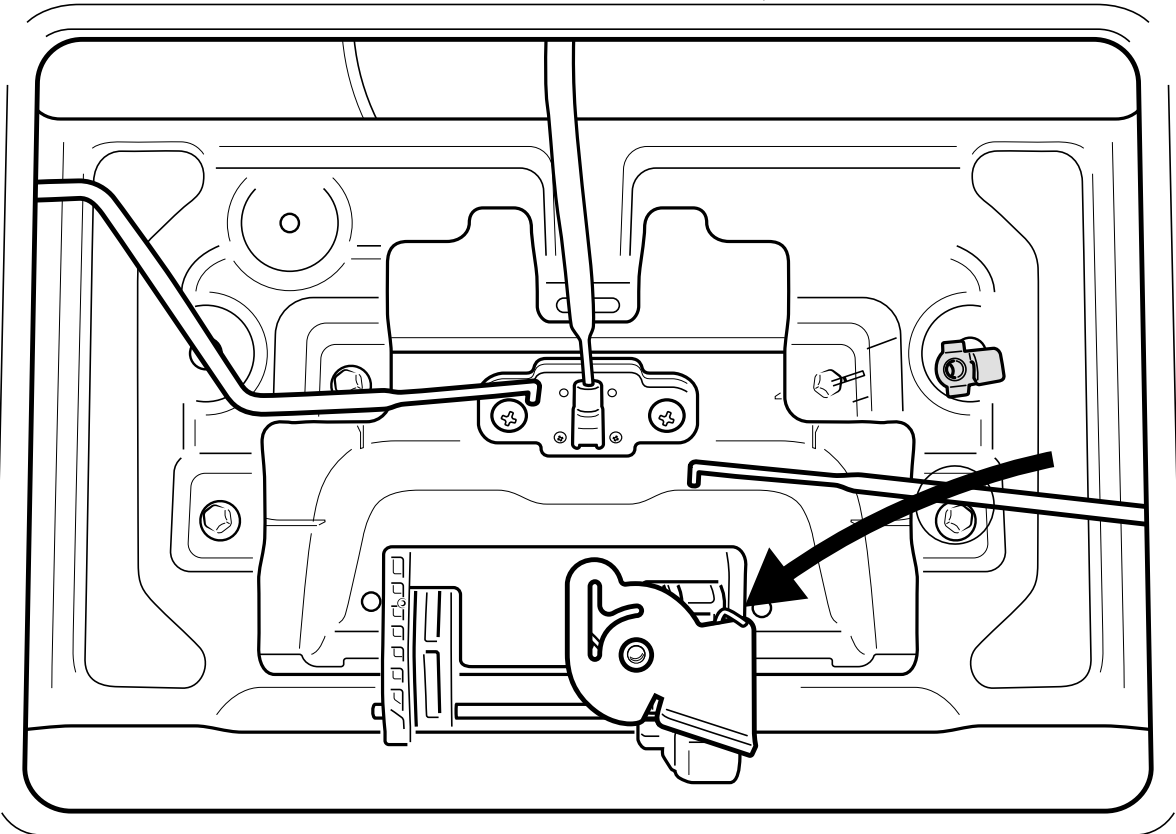



## —STEP 13—

1. Place assembled GW18-1B bracket as indicated.
2. Place M6 washer (part number 46) on top.
3. Fasten using the factory m6 bolt and spring washer.

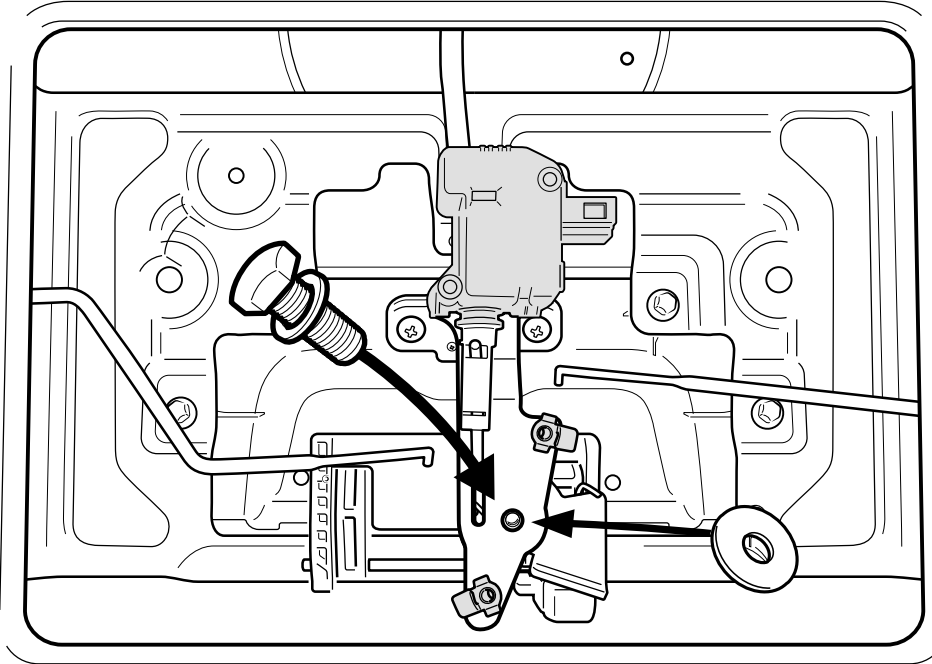

## —STEP 14—

Attach pull rods as indicated and secure by pushing clips in to position.

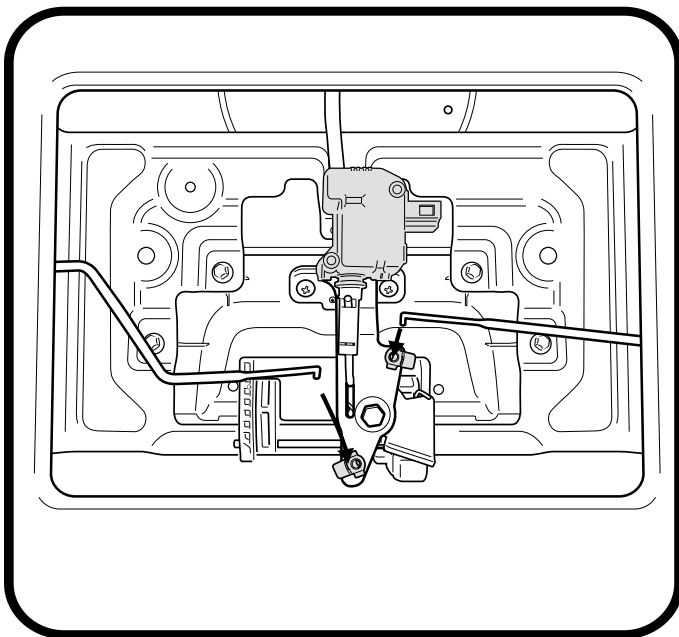

Connect CL-Long- Loom male connector to t ACT-01.

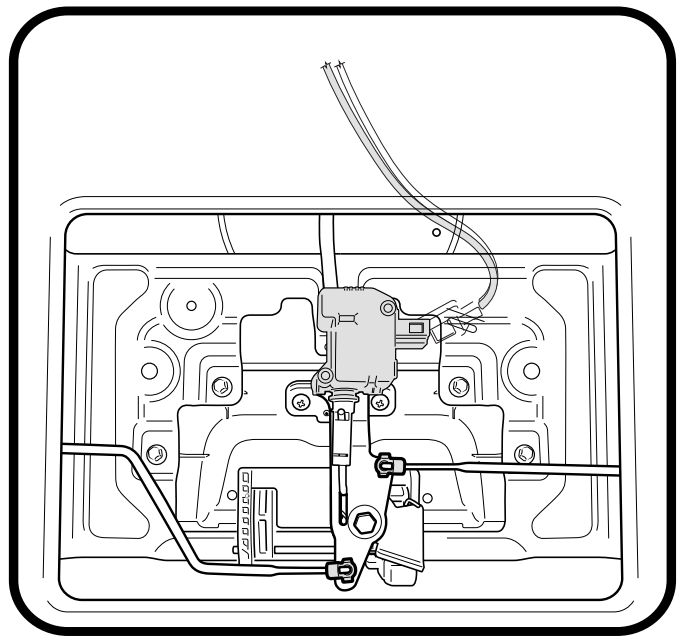

## — STEP 15 —

Run wiring from tailgate to front drivers side kick panel. Cable tie wiring every 500mm over chassis rail. Find the large grommet on the firewall, make a small incision & run the loom through it to enter the cab and towards the kick panel. Seal accordingly.

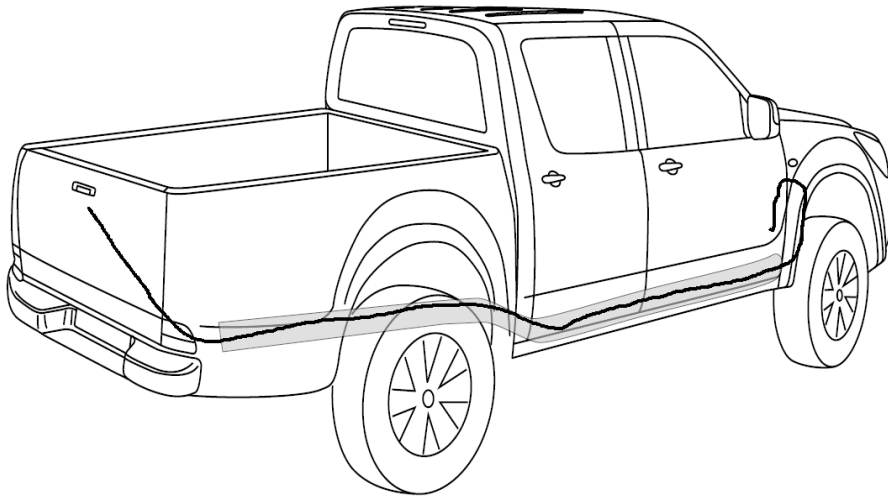

## — STEP 16 —

Carefully remove the drivers side scuff plate.

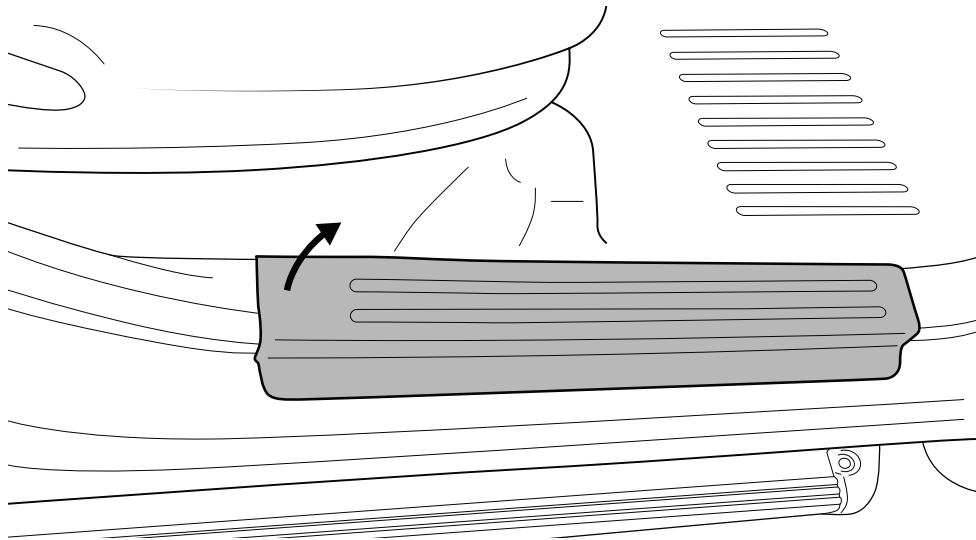

—STEP 17—

Remove kicker panel.

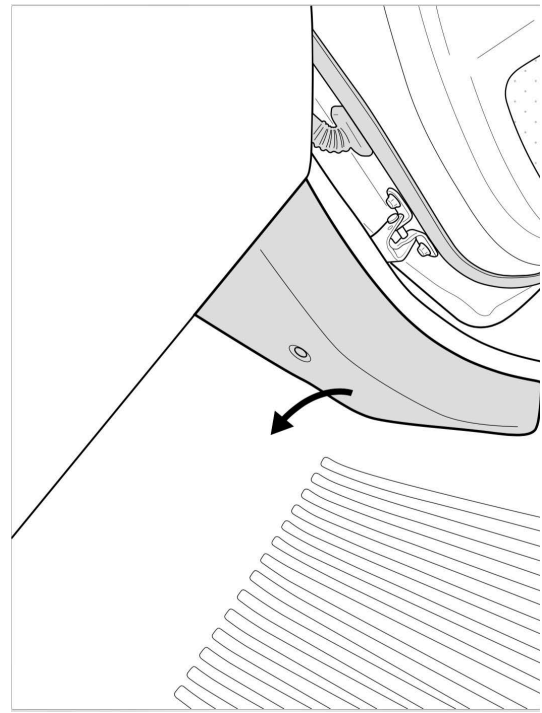

—STEP 18—

locate the central locking loom connector.  
It will be deep in the pillar cavity leading  
towards the door. Now disconnect the  
plug indicated.

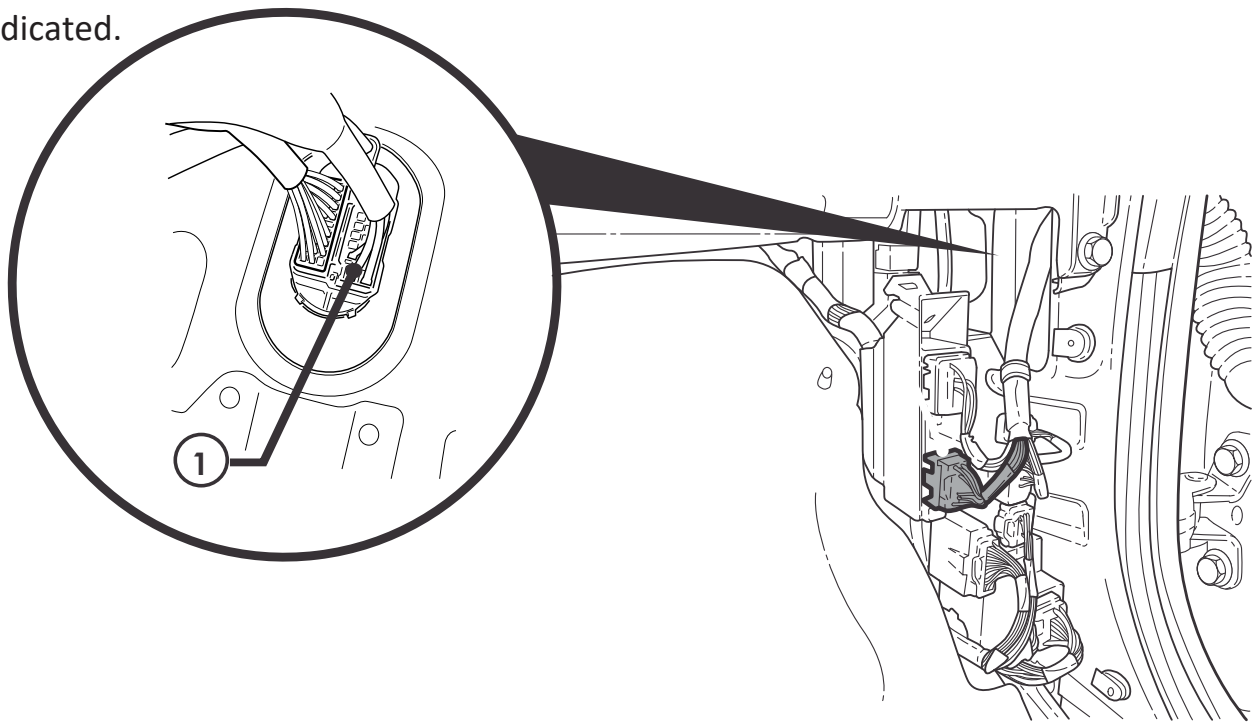

—STEP 19—

connect the GWM-patch connector provided to the vehicle connector (piggyback)

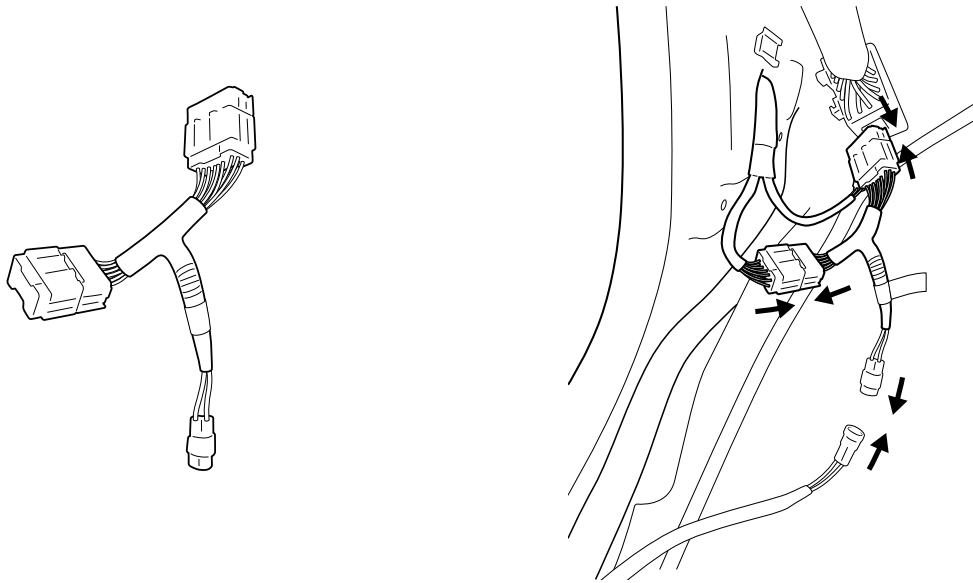

Now connect the GWM -Patch to the CI-Long-

Loom Note: Re-fit kick panel and scuff plate.

—STEP 20—

Place and fasten tail gate cover.

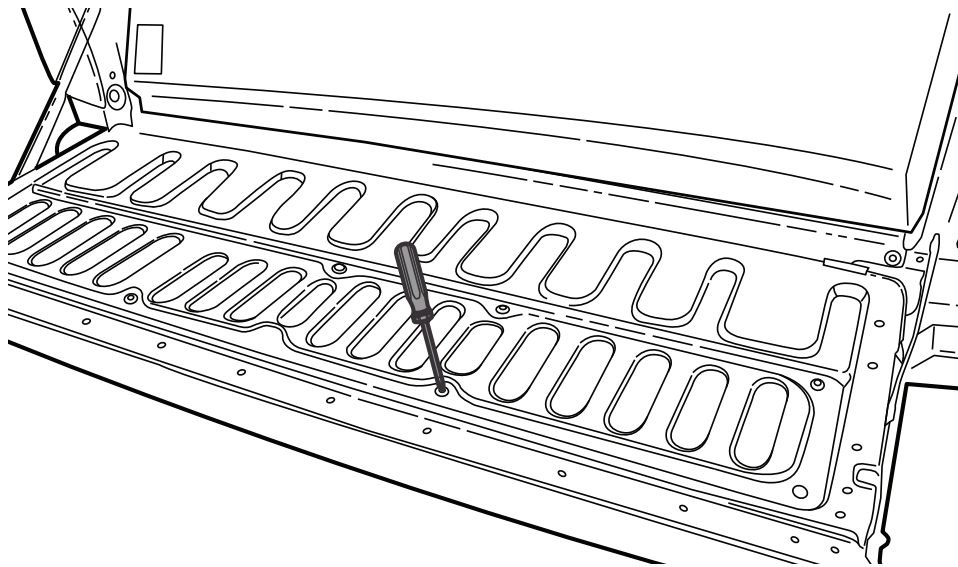

—FITTING COMPLETED—

---